

**Ceiling installation:**

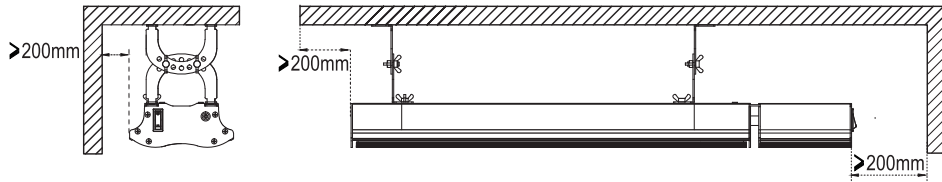

**Wall mounted installation:**

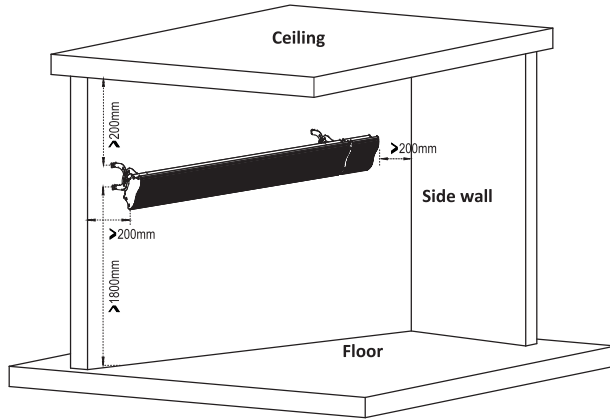

# RADIANT HEATER



**CLEANING AND MAINTENANCE**

- Before maintaining, please unplug the appliance and make sure the heater has cooled down completely.
- Please use soft cloth to wipe the dust on the appliance's surface.
- Do not use gasoline, thinner and any other abrasive cleaners to clean the appliance, as these can damage the surface of appliance.

**TECHNICAL DATA**

Model	RHTER-NOCL-12J/ RHTER-WCL-12D	RHTER-NOCL-18J/ RHTER-WCL-18D	RHTER-NOCL-24J/ RHTER-WCL-24D	RHTER-NOCL-30J/ RHTER-WCL-30D
Operation voltage	220-240V~ 50/60Hz			
Power	1200W	1800W	2400W	3000W

**Model:**

RHTER-NOCL-12J/RHTER-WCL-12D  
 RHTER-NOCL-18J/RHTER-WCL-18D  
 RHTER-NOCL-24J/RHTER-WCL-24D  
 RHTER-NOCL-30J/RHTER-WCL-30D



Recycling – European Directive 2012/19/EU

This marking indicates that this product should not be disposed with other household wastes. To prevent possible harm to the environment or human health from uncontrolled waste disposal, recycle it responsibly to promote the sustainable reuse of material resources. To return your used device, please use the return and collection systems or contact the retailer where the product was purchased. They can take this product for environmental safe recycling.



**BATTERY MUST BE RECYCLED OR DISPOSED OF PROPERLY. DO NOT OPEN. DO NOT DISPOSE**

**OR IN FIRE OR SHORT CIRCUIT.**



Thank you very much for purchasing our products. In order to ensure correct operation, please read this manual and instruction carefully before use.

## IMPORTANT INSTRUCTIONS

When using electrical appliances, basic precautions should always be followed to reduce the risk of fire, electric shock, burns and other injuries.

1. Read and save these instructions. Attention: pictures in the IM are for reference only.
2. This appliance can be used by children aged from 8 years and above and persons with reduced physical, sensory or mental capabilities or lack of experience and knowledge if they have been given supervision or instruction concerning use of the appliance in a safe way and understand the hazards involved.
3. Children shall not play with the appliance.
4. Cleaning and user maintenance shall not be made by children without supervision.
5. Children of less than 3 years should be kept away unless continuously supervised.
6. Children aged from 3 years and less than 8 years shall only switch on/off the appliance provided that it has been placed or installed in its intended normal operating position and they have been given supervision or instruction concerning use of the appliance in a safe way and understand the hazards involved. Children aged from 3 years and less than 8 years shall not plug in, regulate and clean the appliance or perform user maintenance.
7. **CAUTION — Some parts of this product can become very hot and cause burns. Particular attention has to be given where children and vulnerable people are present.**
8. If the supply cord is damaged, it must be replaced by the manufacturer, its service agent or similarly qualified persons in order to avoid a hazard.

## Accessories

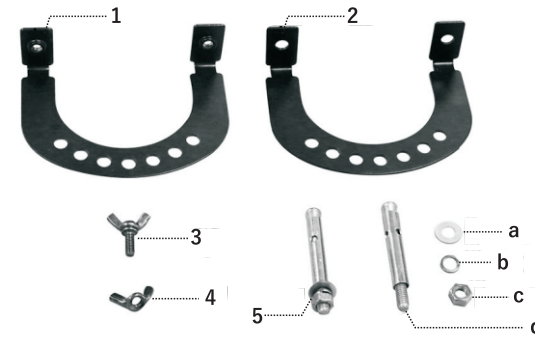

1. Bracket welded with M5 nut for the unit x 2
2. Bracket for the wall x 2
3. Butterfly screw x 8
4. Butterfly nut x 4
5. Expansion screw x 4
  - a. Flat washer
  - b. Spring washer
  - c. Nut
  - d. Threaded rod

## Installation steps

1. Insert the two brackets welded with M5 nut into the grooves on the rear cover of the unit, from the left side (the side without the control box). Move the brackets to your desired position and tighten with the butterfly screws. See picture ①.

(Make sure the two brackets are fixed firmly in a balanced position when the unit is hung up.)

Note: The brackets are welded with the M5 nuts. You can tighten the butterfly screws directly through the nuts (without holes on the unit).

2. Install the rest two brackets to the ceiling or the side wall.
  - Measure the distance between the two brackets on the unit. Measure the distance between the two holes (Approximately 8.5cm) on the bracket for the wall. Drill four holes (Diameter: 6mm; depth: 60mm) on the wall according to below chart.

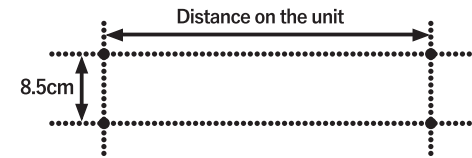

- Remove the nut, spring washer and flat washer from the expansion screws. Insert the expansion screws into the holes on the wall. Put on the brackets through the threaded rods of the expansion screws. Then put back the spring washer, flat washer and the nut. Screw the nut tightly. See picture ②.
3. Hang the unit up by connecting the brackets together. Adjust the unit angle by aligning the holes in the brackets. Fix with the rest butterfly screws and butterfly nuts firmly. See picture ③.

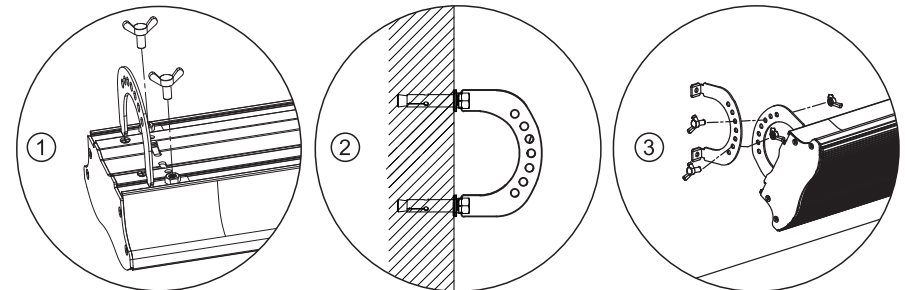

4. Please pay attention to the distance shown in the following "Ceiling installation" and "Wall-mounted installation".

display. The set timer will be activated in 5 seconds without any other operation and then the digital display will show back the ambient temperature.

Note: After timer and temperature are set, the digital display will show the set working time and the ambient temperature alternatively. If you do not set the timer and only set the temperature, the digital display will show the ambient temperature only.

5. This appliance is also equipped with ECO function and lock function.
  - ECO function: You can press the button “ECO” to turn off the working light and only the temperature/timer display will be on. Press the button again, the working light will illuminate again.
  - Lock function: You can press the button “LOCK” and then immediately the button “⏻”, the lock function will be activated. All buttons on the remote control will be invalid when lock function is activated. To deactivate the lock function, press the button “LOCK” and then immediately the button “⏻”.
6. After use, press the button “⏻” on the remote control and the appliance will be in standby. Press the power switch to position “O” and unplug the appliance.

#### Electric memory function

After use, turn off the appliance by the on/off button but not press the power switch to position “O”. Under this condition, if you turn on the appliance again, the appliance will keep working with the temperature you set last time and the timer function will lose efficacy.

RHTER-NOCL-12J/RHTER-NOCL-18J/RHTER-NOCL-24J/RHTER-NOCL-30J

#### PARTS DESCRIPTION



1. Heating plate
2. Control box
3. Indicator light

#### OPERATION

##### Note:

- When the heater is firstly used you may detect some smell and smog. This is normal. The protective oils used on the element during production will burn off at the first use. Allow the appliance to heat up in an open environment and the smell will disappear over a short period of time.
  - Be sure not to use the same socket with other high-power appliance to avoid overloading.
1. Plug in the appliance into an appropriate electrical outlet, power indicator light. and start heating.
  2. Plug in the appliance into an appropriate electrical outlet, the power indicator light off and stop heating.

#### INSTALLATION

##### Warning!

- Do not install on any flammable material.
- Do not cover the heater.
- Only connect to a 220-240VAC power supply.
- The unit must be earthed.
- When ceiling mounted, the distance between the heater and the ceiling must be more than 60mm.
- No objects within 500mm below the heater.

9. This appliance is intended to be used in household and similar applications.
10. The heater must be installed at least 1,8 m above the floor.
11. **WARNING:** This heater is not equipped with a device to control the room temperature. Do not use this heater in small rooms when they are occupied by persons not capable of leaving the room on their own, unless constant supervision is provided.
12. Do not use this heater with a programmer, timer, separate remote-control system or any other device that switches the heater on automatically. Since a fire risk exists if the heater is covered or positioned incorrectly.
13. **WARNING:** In order to avoid overheating, do not cover the heater.
14. The heater must not be located immediately below a socket outlet.
15. Do not use this heater in the immediate surroundings of a bath, a shower or a swimming pool.
16. Make sure the appliance is in good condition after remove it from the package.
17. Check your mains voltage; it must match the specification of this heater.
18. Check the power cord and plug carefully before use to ensure that they are not damaged.
19. Keep children away from the package. Polyethylene bags can be dangerous.
20. Avoid using extension cords, as they may cause a fire hazard due to overheating.
21. Do not allow the power cord to hang (e.g over the edge of a table or counter) or place/run the power cord under rugs, carpeting, or in high-traffic areas where it may be tripped over or pulled.
22. Do not touch the appliance with wet hands. Do not plug or unplug the appliance from the electrical outlet with a wet hand.
23. Keep the power cord and product always away from heated surfaces.

24. Do not insert any other objects into the heater, as it may cause an electric shock, fire or damage to this appliance.
25. Do not use this appliance to dry or heat clothing, shoes, pipes or any other items.
26. Use the appliance in a well-ventilated area, this heater is hot when in use, to avoid burns, do not let bare skin touch a hot surface.
27. Use this heater only as described in the manual, any other use not recommended by the manufacturer may cause fire, electric shock or personal injury.
28. This heating device is not suitable for assembling in vehicles and machines.
29. Do not immerse the unit in water.
30. To avoid the risk of fire or electric shock do not remove the housing.



31.  Means “DO NOT COVER “.
32. Do not use this product near a window because rain may cause electric shock.
33. Do not place the appliance close to a radiant heat source. Do not use the appliance in areas where near the gasoline, paint or other flammable liquids are used or stored.
34. Do not twist, kink or warp the cord around the appliance, as this may cause damages.
35. Do not connect the appliance to the mains voltage until the appliance is completely installed and adjusted.
36. Switch off the appliance and let the surface cool before moving.
37. The most common cause of overheating is deposits of dust or fluff in the heater. Ensure these deposits are removed regularly by unplugging the heater and vacuum cleaning air vents and grilles.
38. Do not cover the grilles, block entry or exhaust of airflow by placing appliance against any surface. Keep all object at least 1 meter from the front, side and rear of appliance.

RHTER-WCL-12D/RHTER-WCL-18D/RHTER-WCL-24D/RHTER-WCL-30D

PARTS DESCRIPTION



1. Heating plate
2. Control box
3. Power switch
4. Digital display

Remote control

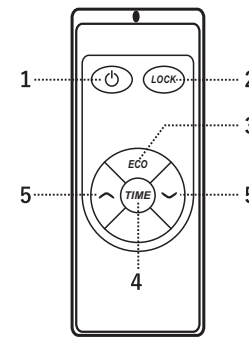

1. On/off button
2. Lock button
3. Eco button
4. Timer button
5. Adjustment button

Digital display

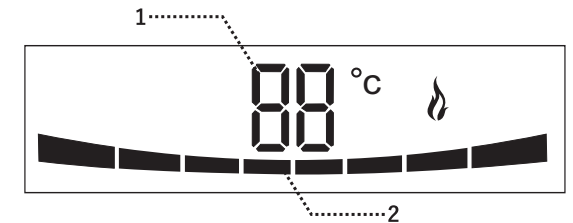

1. Temperature/Timer display
2. Working light

OPERATION

Note:

- This appliance is equipped with a remote control for operation. One piece of CR2032 battery should be used for it.
  - When the heater is firstly used you may detect some smell and smog. This is normal. The protective oils used on the element during production will burn off at the first use. Allow the appliance to heat up in an open environment and the smell will disappear over a short period of time.
  - Be sure not to use the same socket with other high-power appliance to avoid overloading.
1. Plug in the appliance into an appropriate electrical outlet. Turn on the appliance by pressing the power switch to position “I”. A beep sound will be heard. The appliance is standby with “— —” flashing on the digital display.
  2. Press the on/off button “⏻” on the remote control to start setting your heater. the digital display shows the current ambient temperature.
  3. Press the button “^” or “v” to set your desired temperature by increasing/decreasing 1°C, between 5°C to 45°C. The corresponding temperature value will be shown on the digital display. The set temperature will be activated in 5 seconds without any other operation and then the digital display will show back the ambient temperature.  
The appliance will automatically maintain your setting temperature with the working light on and off. The unit will stop working when the ambient temperature is above the setting temperature by 3°C and resume work when the ambient temperature is below the setting temperature by 1°C.
  4. Press the timer button “TIME” and then the button “^” or “v” to set your desired working time by increasing/decreasing 1 hour, within 9 hours. The corresponding timer value will be shown on the digital