



REFRIGERATOR

Four Door



Warning:
Before using this product,
please read this manual carefully
and keep it for future reference.
The design and specifications
are subject to change without
prior notice for product
improvement. Consult with your
dealer or manufacturer for
details.

version:003-8-2021



EN

USER MANUAL

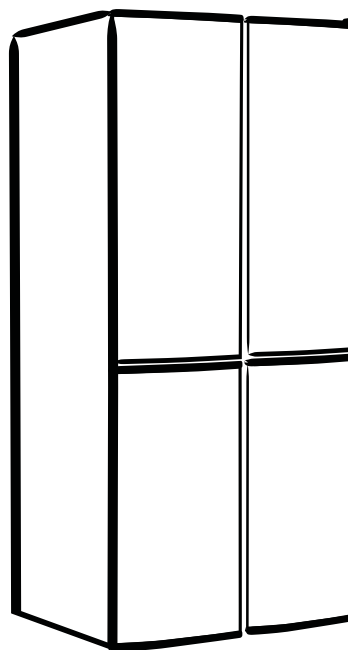

MODEL: MDRF632FGF46APD

www.midea.com

Dear user

THANK YOU and CONGRATULATIONS on your purchase of this high-quality Midea product. Your Midea refrigerator is designed for reliable, trouble-free performance.

For future reference, please record your product model and serial number on the back of the product or above the compressor compartment on the right.

Model Number _____

Serial Number _____

1.SAFETY INFORMATION	3
2.PROPER USE OF REFRIGERATOR	11
2.1 PLACEMENT	11
2.2 ENERGY SAVING TIPS	12
2.3 CHANGING THE LIGHT	12
2.4 START TO USE	13
2.5 COMPONENTS	14
2.6 FUNCTIONS	15
2.7 OPERATING INSTRUCTIONS.....	16
2.8 LEVELING DOORS	19
2.9 LEVELING FEET	19
3.MAINTENANCE OF REFRIGERATOR.....	20
3.1 OVERALL CLEANING.....	20
3.2 CLEANING DOOR TRAY	21
3.3 DEFROSTING.....	21
3.4 OUT OF OPERATION	21
4.TROUBLE SHOOTING.....	22
5.APPENDIX	23

1. SAFETY INFORMATION

YOUR SAFETY AND THE SAFETY OF OTHERS ARE VERY IMPORTANT

To prevent injury to the user or other persons and property damage, these instructions must be followed. Incorrect operation due to ignoring instructions may cause harm or damage, including death.

The level of risk is shown by the following indications.



Prohibition symbol

This is a prohibition symbol.

Any incomppliance with instructions marked with this symbol may result in damage to the product or endanger the personal safety of the user.



Warning symbol

This is a warning symbol.

It is required to operate in strict observance of instructions marked with this symbol; otherwise damage to the product or personal injury may be caused.



Cautioning symbol

This is a cautioning symbol.

Instructions marked with this symbol require special caution. Insufficient caution may result in slight or moderate injury or damage to the product.

IMPORTANT SAFETY INSTRUCTIONS



Risk of fire / Flammable materials

WARNING

- This appliance is intended to be used in household and similar applications such as staff kitchen areas in shops, offices and other working environments; farm houses and by clients in hotels, motels and other residential type environments; bed and breakfast type environments; catering and similar non-retail applications.
- This appliance is not intended for use by persons (including children) with reduced physical, sensory or mental capabilities, or lack of experience and knowledge, unless they have been given supervision or instruction concerning use of the appliance by a person responsible for their safety.



- Children should be supervised to ensure that they do not play with the appliance.
- If the supply cord is damaged, it must be replaced by the manufacturer, its service agent or similarly qualified persons in order to avoid a hazard.
- Do not store explosive substances such as aerosol cans with a flammable propellant in this appliance.
- The appliance has to be unplugged after use and before carrying out user maintenance.
- **WARNING:** Keep ventilation openings in the appliance enclosure or in the built-in structure clear of obstructions.
- **WARNING:** Do not use mechanical devices or other means to accelerate the defrosting process, other than those recommended by the manufacturer.
- **WARNING:** Do not damage the refrigerant circuit.
- **WARNING:** Do not use electrical appliances inside the food storage compartments of the appliance, unless they are of the type recommended by the manufacturer.
- **WARNING:** Please dispose of the refrigerator according to local regulations since it uses flammable blowing gas and refrigerant.
- **WARNING:** When positioning the appliance, ensure the supply cord is not trapped or damaged.
- **WARNING:** Do not place multiple portable socket-outlets or portable power supplies at the rear of the appliance.
- **WARNING:** Do not use extension cords or ungrounded (two prong) adapters.
- **WARNING:** To avoid a hazard due to instability of the appliance, it must be fixed in accordance with the instructions.
- To Prevent Children From Being Entrapped, The Keys Must Be Kept Out Of Reach Of Children And Not In The Vicinity Of Chest Freezer (Or Refrigerator) (suitable for products with locks).



DANGER

- Risk of child entrapment. Before you dispose of your old refrigerator or chest freezer:
 - Take off the doors.
 - Leave the shelves in place so that children may not easily climb inside.
- The refrigerator must be disconnected from mains power before attempting the installation of accessories.
- Refrigerant and cyclopentane foaming material used for the appliance are flammable. Therefore, when the appliance is scrapped, it shall be kept away from any fire source and be recovered by a special recovering company with corresponding qualification other than be disposed by combustion, so as to prevent damage to the environment or any other harm.
- For doors or lids fitted with locks, the keys must be kept out of reach of children and not in the vicinity of the refrigerating appliance, in order to prevent children from being locked inside.

Safety
Information

Proper Use of
Refrigerator





Maintenance of
Refrigerator

Trouble
Shooting

Appendix

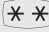
WARNING

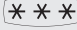
For EU standard:

- This appliance can be used by children aged from 8 years and above and persons with reduced physical, sensory or mental capabilities or lack of experience and knowledge if they have been given supervision or instruction concerning the use of the appliance in a safe way and understand the hazards involved. Children shall not play with the appliance. Cleaning and user maintenance shall not be made by children without supervision. Children aged from 3 to 8 years are allowed to load and unload refrigerating appliances.
 - To avoid contamination of food, please observe the following instructions:
 - Opening the door for long periods of time can cause a significant increase of the temperature in the compartments of the appliance.
 - Clean regularly surfaces that can come in contact with food and accessible drainage systems.
 - Clean water tanks if they have not been used for 48h; flush the water system connected to a water supply if water has not been drawn for 5 days. (Note 1)
 - Store raw meat and fish in suitable containers in the refrigerator, so that it is not in contact with or drip onto other food.
 - Two-star  frozen-food compartments are suitable for storing pre-frozen food, storing or making ice-cream and making ice cubes. (Note 2)
 - One-star , two-star  and three-star  compartments are not suitable for freezing fresh food. (Note 3)
 - For appliances without a 4-star  compartment: this refrigerating appliance is not suitable for freezing foodstuffs. (Note 4)
 - If the refrigerating appliance is left empty for long periods of time, switch off, defrost, clean, dry, and leave the door open to prevent mould developing within the appliance.
- Notes 1, 2, 3, 4: Please confirm whether it is applicable according to your product.
- For a freestanding appliance: this refrigerating appliance is not intended to be used as a built-in appliance.
 - Any replacement or maintenance of the LED lamps is intended to be made by the manufacturer, its service agent or similar qualified persons.
 - This product contains two light sources of energy efficiency class (G).

SAVE THESE INSTRUCTIONS

THIS APPLIANCE IS FOR HOUSEHOLD USE ONLY

State of California Proposition 65 Warnings:

 **WARNING:** Cancer and Reproductive Harm
-www.P65Warnings.ca.gov.

PROPER DISPOSAL

WARNING

Suffocation Hazard

Before you dispose of your old chest freezer or refrigerator:

- Remove the door or lid so that children cannot hide or get trapped inside your old appliance.
- Leave any shelves in place so that children may not easily climb inside.
- Failure to follow these instructions can result in death or brain damage.

IMPORTANT:

Flammable gas and refrigerant used. It is the consumer's responsibility to comply with Federal and Local regulations when disposing of this product. Refrigerants must be evacuated by a licensed, EPA-certified refrigerant technician in accordance with established procedures.

Safety
Information

Proper Use of
Refrigerator

Maintenance of
Refrigerator

Trouble
Shooting

Appendix



ELECTRICITY-RELATED WARNINGS

- Do not pull the power cord when pulling the power plug of the refrigerator. Please firmly grasp the plug and pull out from the socket.
- To ensure safe use, do not damage the power cord or use the power cord when it is damaged or worn.
- Please use a dedicated power socket; the power socket shall not be shared with other electrical appliances.

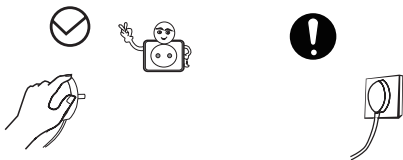

- The power cord should be firmly contacted with the socket, otherwise fire may be caused.
- Please ensure that the grounding electrode of the power socket is equipped with a reliable grounding line.
- Please turn off the valve of leaking gas and open the doors and windows in case of leakage of gas and other flammable substances. Do not unplug the refrigerator and other electrical appliances considering that spark may cause a fire.

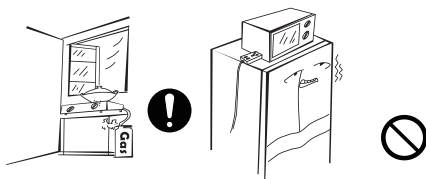

- Do not use electrical appliances on top of the appliance, unless they are of the type recommended by the manufacturer.

WARNINGS RELATED TO PLACING ITEMS

- Do not place flammable, explosive, volatile and highly corrosive items in the refrigerator to prevent damages to the product or fire accidents.
- Do not place flammable items near the refrigerator to avoid fire.

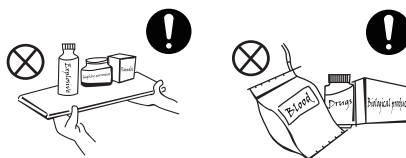

- This product is a household refrigerator and is only suitable for the storage of food. According to national standards, a household refrigerator shall not be used for other purposes, such as storage of blood, drugs or biological products.
- Do not store beer, beverages or other fluids contained in bottles or enclosed containers in the freezing chamber of the refrigerator, otherwise the bottles or enclosed containers may crack due to freezing and cause damages.



Safety Information

Proper Use of Refrigerator

Maintenance of Refrigerator

Trouble Shooting

Appendix



WARNINGS FOR USE

- Do not arbitrarily disassemble or reconstruct the refrigerator, nor damage the refrigerant circuit; maintenance of the appliance must be conducted by a specialist.
- A damaged power cord must be replaced by the manufacturer, its maintenance department or related professionals in order to avoid danger.

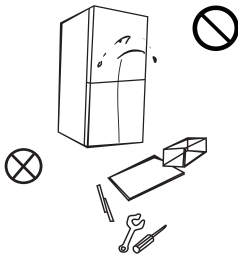

- The gaps between refrigerator door and body are small. Do not place your hands in these areas to prevent squeezing your fingers. Please be gentle when opening the refrigerator door to avoid articles falling out.
- Do not pick up food or containers with wet hands in the freezing chamber when the refrigerator is running, especially metal containers in order to avoid frostbite.

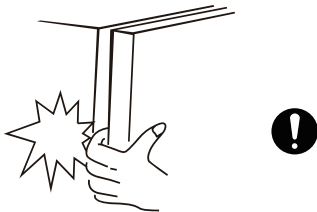

- Do not allow children to enter or climb inside the refrigerator to prevent that children are sealed in the refrigerator or injured by the falling refrigerator.
- Do not spray or wash the refrigerator; do not place the refrigerator in moist places easy to be splashed with water so as not to affect the electrical insulation properties of the refrigerator.



- Do not place heavy objects on top of the refrigerator considering that objects may fall when opening the door, and accidental injuries might be caused.
- Please pull out the plug in case of power failure or cleaning. Do not connect the refrigerator to power supply within five minutes to prevent damages to the compressor due to successive starts.

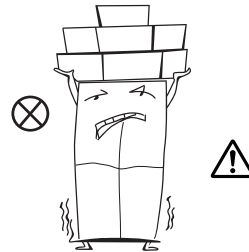

Safety Information

Proper Use of Refrigerator

Maintenance of Refrigerator

Trouble Shooting

Appendix



ENERGY WARNINGS

- 1.** Refrigerating appliances might not operate consistently (possibility of defrosting of contents or temperature becoming too warm in the frozen food compartment) when set for an extended period of time below the cold end of the temperature range for which the refrigerating appliance is designed.
- 2.** Sparkling beverages shall not be stored in a freezing chamber or a lower temperature compartment. Certain drinks (such as ice water) shall not be too cold for drinking.
- 3.** Do not exceed the storage time(s) recommended by the food manufacturers for any kind of food and particularly for commercially quick-frozen food in food-freezer and frozen-food storage compartments or cabinets.
- 4.** Prevent an undue rise in temperature of frozen food while defrosting the refrigerating appliance, such as wrapping the frozen food in several layers of newspaper.
- 5.** A rise in temperature of frozen food during manual defrosting, maintenance or cleaning can shorten the storage life.

DISPOSAL



Refrigerant and cyclopentane foaming material used for the refrigerator are flammable. Therefore, when the refrigerator is scrapped, it shall be kept away from any fire source and be recovered by a special recovering company with corresponding qualification other than be disposed by combustion, so as to prevent damage to the environment or any other harm.



When the refrigerator is scrapped, disassemble the doors, and remove gaskets of door and shelves; place the doors and shelves in a proper place, so as to prevent trapping children.

Correct Disposal of this product:



This marking indicates that this product should not be disposed with other household waste. To prevent possible harm to the environment or human health from uncontrolled waste disposal, recycle it responsibly to promote the sustainable reuse of material resources. To return your used device, please use the return and collection systems or contact the retailer where the product was purchased. They take this product in for environmental safe recycling.



2. PROPER USE OF REFRIGERATOR

2.1 PLACEMENT

- Before use, remove all packing materials, including bottom pads, foam pads and tapes inside of the refrigerator; tear off the protective film on the doors and the refrigerator body.

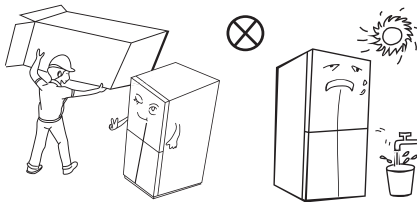

- Keep away from heat and avoid direct sunlight. Do not place the refrigerator in moist or wet places to prevent rust or reduction of the insulating effect.
- Do not spray or wash the refrigerator; do not place the refrigerator in moist places easy to be splashed with water so as not to affect the electrical insulation properties of the refrigerator.

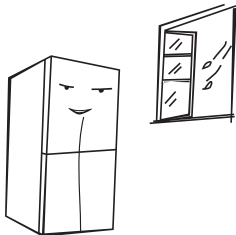

- The space on top of the refrigerator shall be greater than 30cm, and the refrigerator should be placed against a wall with a distance of more than 10cm to facilitate heat dissipation.

- Spare enough space for convenient opening of doors and drawers according to the statement of the distributor.

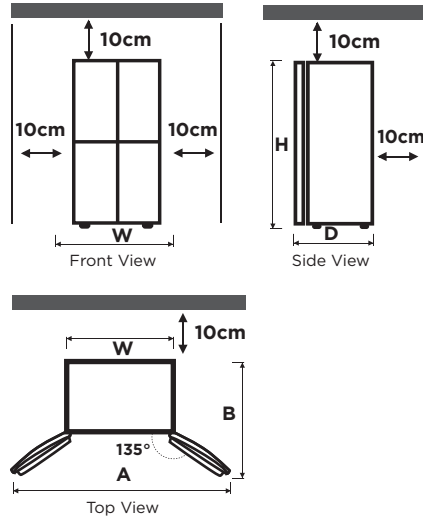

The measurements in the above table may differ, depending on the measuring method.

NOTE

This refrigerator needs to be installed independently and cannot be built-in. Otherwise, it will cause problems such as failure to install, performance and life of the product are reduced. Also, the manufacturer does not provide basic product warranty.



2.2 ENERGY SAVING TIPS

- The appliance should be located in the coolest area of the room, away from heat producing appliances or heating ducts, and out of direct sunlight.
- Let hot foods cool down to room temperature before placing it in the appliance. Overloading the appliance forces the compressor to run longer. Food that freezes too slowly may lose quality, or spoil.
- Be sure to wrap food properly, and wipe containers dry before placing them in the appliance. This cuts down on frost build-up inside the appliance.
- Appliance storage bins should not be lined with tin foil, wax paper, or paper toweling. Liners interfere with cold air circulation, making the appliance less efficient.
- Organize and label food to reduce door openings and extended searches. Remove as many items as needed at one time, and close the door as soon as possible.

2.3 CHANGING THE LIGHT

- Any replacement or maintenance of the LED lamps is intended to be made by the manufacturer, its service agent or similar qualified persons.

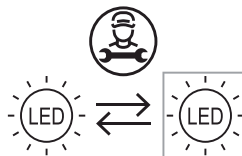

The light source in this product is only to be replaced by qualified engineers.

	1. First remove the plug.
	2. Remove the light cover with a screwdriver.
	3. Take down the lamp panel.
	4. Remove the connection terminal.



2.4 START TO USE

- Before initial start, keep the refrigerator still for two hours before connecting it to power supply.
- Before placing any fresh or frozen foods, the refrigerator should have run for 2 - 3 hours, or for above 4 hours in summer when the ambient temperature is high.

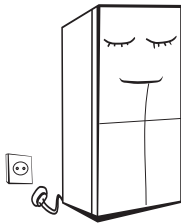

NOTE

This product is not recommended for use with sockets or main switch with A/GFCI function, otherwise it may cause tripping.

- 1. It does not pose a safety risk when tripped.**
- 2. If tripping persists, it is recommended to replace the socket or main switch without A/GFCI function.**

2.5 COMPONENTS

(Refrigerating chamber)

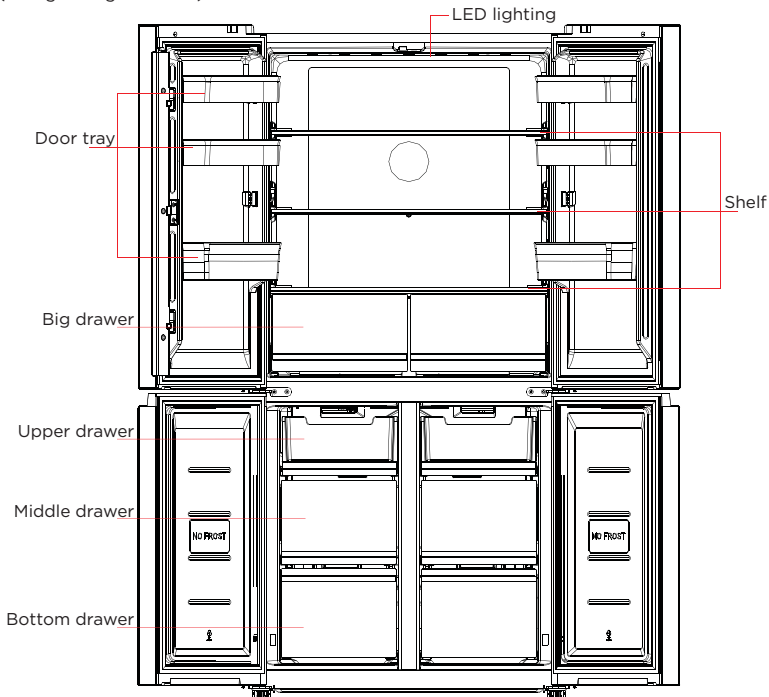

The picture above is only for reference. The actual configuration will depend on the physical product or statement by the distributor

Refrigerating chamber

- The Refrigerating Chamber is suitable to store a variety of fruits, vegetables, beverages and other food consumed in the short term; suggested storage time 3 to 5 days.
- Cooked food should not be placed in the refrigerating chamber until cooled down to room temperature.
- Food is recommended to be sealed up before placing it into the refrigerator.
- The glass shelves can be adjusted up or down for proper storage space and easy use.

Freezing chamber

- The low temperature freezing chamber may keep food fresh for a long time and it is mainly used to store frozen food and making ice.
- The freezing chamber is suitable to store meat, fish, rice balls and other food not to be consumed short-term.
- Chunks of meat are preferably to be divided into small pieces for quick freezing and easy access. Please note that food should be consumed within the shelf life.
- Freezing capacity value is marked on the rating label.



IMPORTANT:

Drawers, food boxes, shelves, etc. placed according to the position in the picture above are the most energy efficient.

When the product is tested according to IEC 62552:2007, the test conditions are as follows: Remove the middle drawer of the freezing compartment and move the upper drawer to the middle drawer position.

NOTE

Storage of too much food during operation after the initial connection to power may adversely affect the freezing effect of the refrigerator. Food stored should not block the air outlet; or otherwise the freezing effect will also be adversely affected

2.6 FUNCTIONS

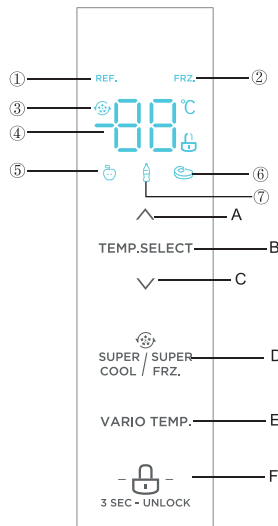

The picture above is only for reference. The actual configuration will depend on the physical product or statement by the distributor

1. Screen

- ① Refrigerator icon
- ② Freezer icon
- ③ Super cool/freezing icon
- ④ Temperature display icon
- ⑤ Fruit/vegetable icon
- ⑥ Meat icon
- ⑦ Drink icon

2. Control buttons

- A. Temperature up button
- B. Temperature zone selection button
- C. Temperature down button
- D. Super cool/freezing button
- E. Variable temperature button
- F. Lock/unlock button









2.7 OPERATING INSTRUCTIONS



Display

- The first time the power is turned on, the complete display will light up for 3 seconds. The starting beep sounds and the screen enters normal operation. First time using the refrigerator, temperatures of the refrigerating and freezing chambers should be set to 5°C and -18°C respectively.
- In case of error, the display shows the error code in the refrigerating temperature display area (see next page); during normal operation, the display shows the set temperature of the cooling compartment.
- Under normal circumstances, if there is no any manual operation of the refrigerator for 30 seconds, the control panel will lock automatically, and in locked state, the display light will go out after 30 seconds.



Lock /unlock

- In unlocked state, press and hold the lock button  for 3 seconds to enter the lock state.
- The logo  goes out and the buzzer sounds to confirm that the display panel is locked, all buttons are locked.
- In locked state, press and hold the lock button  for 3 seconds to enter the unlocked state.
- The logo  lights up and the buzzer sounds to confirm that the display panel is unlocked, all buttons are working again.

Temperature setting of refrigerating chamber

- Press the temperature zone selection button **TEMP.SELECT** to choose the setting temperature zone of the refrigerating chamber, then press button  or  to adjust the setting temperature of the refrigerating chamber. The temperature setting range for the refrigerating chamber is 2°C to 8°C.

Temperature setting of freezing chamber

- Press the temperature zone selection button **TEMP.SELECT** to choose the setting temperature zone of the freezing chamber, then press button  or  to adjust the setting temperature of the freezing chamber. The temperature setting range for the freezing chamber is -24°C to -16°C.





Temperature setting of variable temperature chamber

- Press the vario temperature button **VARIO TEMP.** to adjust the setting temperature of the vario chamber, the adjusting range is fruit/vegetables, drinks and meat.

Mode setting

- When super cool mode **SUPER COOL** is set, the temperature of the refrigerating chamber is automatically set to 2°C; super cool mode is exited after 6 hours.
- Exit super cool mode **SUPER COOL** mode, and the temperature of the refrigerating chamber will automatically return to the previously set temperature.
- When super freezing mode **SUPER FRZ.** is set, the temperature of the freezing chamber is automatically set to -24°C; defrosting starts after 18 hours and the mode is exited after 24 hours.
- Exit super freezing mode **SUPER FRZ.**, and the temperature of the freezing chamber will automatically return to the previously set temperature.
- According to IEC62552:2007, the testing condition is as follows: start the super freezer mode in advance, and wait until the fridge enters automatic defrosting, then apply the freezer load.
- The maximum defrosting time is 72 hours and the minimum is 12 hours at 32°C.
- Recommended setting: refrigerating chamber 4°C, freezing chamber -18°C.

Sabbath mode

- Unlock the fridge, then simultaneously press and hold the **✓** and lock buttons for 4 seconds to access Sabbath mode. Press any key to exit. In this mode the fridge status is as follows:
 - a. Display control board and lights remain off, no alarm.
 - b. The refrigerator cools normally.
 - c. Within five minutes of opening the door, compressor and fan motor status do not change.

Storage upon power failure

- In case of power failure, the working mode will be locked and maintained until the power is back.





Fault indication

- The following warnings appearing on the display indicate corresponding faults of the refrigerator. Though the refrigerator may still have cold storage function with the following faults, please contact a maintenance specialist to ensure optimized operation of the appliance.

Error code	Error description
E1	Temperature sensor failure of refrigerating chamber
E2	Temperature sensor failure of freezing chamber
E3	Temperature sensor failure of vario chamber
E4	Failure defrosting sensor in the refrigerating chamber
E5	Freezing defrost sensor detection circuit error
E6	Communication error
E7	Circulation of temperature detection circuit error
EH	Moisture sensor error

NOTE

When the set temperature of the freezer changes, if set relevant function mode (e.g. quick-cold mode, quick-freezer mode, quick-cold and freezer mode, vocation mode), the relevant function mode should be quit or canceled at once.

NOTE

The quick freezing function is designed to maintain the nutritional value of the food in the freezer. It can freeze the food in the shortest possible time. If a large amount of food is frozen at one time, we recommend turning on the quick-freezing function. At this time, the freezing speed of the freezer compartment is increased, which can quickly freeze the food, effectively lock the nutrition of the food, and facilitate storage. In case of power failure, the working mode is locked and maintained.



2.8 LEVELING DOORS

Precautions before operation:

- Before making changes the refrigerator must be disconnected from power. Before adjusting the door, precautions should be taken to prevent any personal injury.
- Schematic diagram of leveling the door body

List of tools to be provided to the user	
	pliers

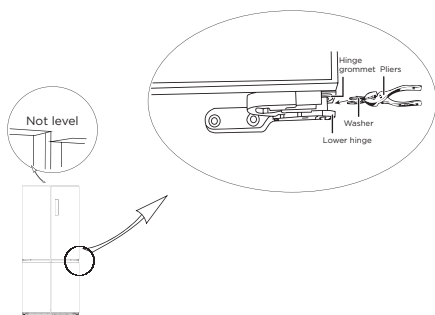

The picture above is only for reference. The actual configuration will depend on the physical product or statement by the distributor

- 1) Raise the lower door up to the level of the higher door.
- 2) Insert the supplied washers in the gap between the hinge grommet and the lower hinge by using pliers. The number of washers you will need to insert depends on the gap.

When the fridge door is low:

Open the door; use a wrench to loosen the locking nut and to turn the adjusting nut counter-clockwise to raise the door. Once the doors are aligned, tighten the locking nut by turning it anti-clockwise.

When the fridge door is high:

Open the door; use a wrench to turn the adjusting nut clockwise to lower the door. Once the doors are aligned, tighten the locking nut by turning it anti-clockwise.

2.9 LEVELING FEET

1) Precautions before operation:

Before making changes the refrigerator must be disconnected from power.

Before adjusting the leveling feet, precautions should be taken to prevent any personal injury.

2) Schematic diagram of leveling feet

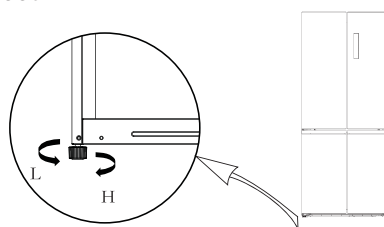

3) Adjusting procedures:

- a. Turn the feet clockwise to raise the refrigerator.
- b. Turn the feet counter-clockwise to lower the refrigerator.
- c. Adjust the right and left feet based on the procedures above to a horizontal level.

IMPORTANT:

The picture above is only for reference. The actual configuration will depend on the physical product or statement by the distributor

3. MAINTENANCE OF REFRIGERATOR

3.1 OVERALL CLEANING

- Dust behind the refrigerator and on the floor must be cleaned to improve the cooling effect and energy saving.
 - Check the door gasket regularly to make sure there is no debris. Clean the door gasket with a soft cloth dampened with soapy water or diluted detergent.
 - The interior of the refrigerator should be cleaned regularly to avoid odors.
 - Please turn off the power before cleaning the interior, remove all food, drink, shelves, drawers, etc.
 - Use a soft cloth or sponge to clean the inside of the refrigerator with two tablespoons of baking soda and a quart of warm water. Then rinse with water and wipe clean. After cleaning, open the door and let it dry naturally before turning on the power.
 - For areas that are difficult to clean inside the refrigerator (such as narrow places, gaps or corners), we recommend to wipe them regularly with a soft rag, soft brush, etc. and when necessary, with some tools (such as thin sticks) to ensure no contaminants or bacterial accumulation in these areas.
 - Do not use soap, detergent, scrub powder, spray cleaner, etc., as these may cause odors inside the refrigerator or contaminate food.
- Clean the door tray, shelves and drawers with a soft cloth dampened with soapy water or diluted detergent. Dry with a soft cloth or dry naturally.
 - Wipe the outer surface of the refrigerator with a soft cloth dampened with soapy water, detergent, etc., and then wipe dry.
 - Do not use hard brushes, scouring pads, wire brushes, abrasives (such as toothpaste), organic solvents (such as alcohol, acetone, banana oil, etc.), boiling water, acid or alkaline items, which may damage the fridge surface and interior. Boiling water and organic solvents such as benzene may deform or damage plastic parts.
 - Do not rinse directly with water or other liquids during cleaning to avoid short circuit or affect electrical insulation after immersion.



Unplug the refrigerator for defrosting and cleaning.

3.2 CLEANING DOOR TRAY

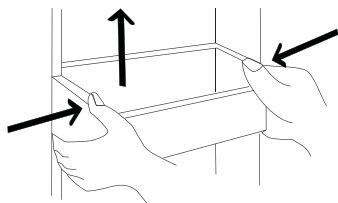

The picture above is only for reference. The actual configuration will depend on the physical product or statement by the distributor

- Use both hands to squeeze the tray and push it upward to remove it (see arrows in the Figure below).
- You can adjust the installation height according to your requirement.

3.3 DEFROSTING

- The refrigerator is made based on the air-cooling principle and thus has automatic defrosting function. Frost formed due to change of season or temperature may also be manually removed by disconnection of the appliance from power supply or by wiping with a dry towel.

3.4 OUT OF OPERATION

- Power failure: In case of power failure, even if it is in summer, food inside the appliance can be kept for several hours; during the power failure, the times of opening the doors must be reduced, and no more fresh food should be placed into the appliance.
- Long-term non-use: Unplug and clean the appliance and leave the doors open to prevent odors.
- Moving: Before the refrigerator is moved, take all objects out, fix the glass partitions, vegetable holder, freezing chamber drawers etc. with tape, and tighten the leveling feet; close the doors and fix them with tape. During the move, the appliance must not be laid upside down or horizontally, or be exposed to strong vibration; the inclination during the move should be no more than 45°.

IMPORTANT:

The appliance shall run continuously once it is started. Generally, the operation of the appliance shall not be interrupted; otherwise the service life may be impaired

Safety Information

Proper Use of Refrigerator

Maintenance of Refrigerator

Trouble Shooting

Appendix

4. TROUBLE SHOOTING

The following simple issues can be handled by the user. Please call the after-sale service department if the issues are not solved.

Safety Information	Malfunction	Check whether the appliance is connected to power or whether the plug is inserted properly. Check whether the voltage is too low. Check whether there is a power failure or circuits have tripped.
	Odor	Odorous food should be tightly wrapped. Check whether there is any rotten food. Clean the inside of the refrigerator.
Proper Use of Refrigerator	Long operation of the compressor	Long operation of the refrigerator is normal in summer when the ambient temperature is high. We do not suggest placing too much food in the appliance at the same time. Food must cool down before being placed in the appliance. The doors are opened too frequently.
Maintenance of Refrigerator	Light fails to turn on	Check whether the refrigerator is connected to power supply and whether the illuminating light is damaged. Have the light replaced by a specialist.
Trouble Shooting	Door cannot be properly closed	The door is stuck by food packages. Too much food inside. The refrigerator is tilted.
	Loud noises	Check whether the floor is level and whether the refrigerator is placed in a stable position. Check whether accessories are placed at proper locations.
Appendix	Door seal fails to be tight	Remove foreign matters on the door seal. Heat the door seal and then cool it for restoration (or blow it with an electrical drier or use a hot towel for heating).
	Water pan overflows	There is too much food in the chamber or food stored contains too much water, resulting in heavy defrosting. The doors are not closed properly, resulting in frosting due to entry of air and increased water due to defrosting.
	Hot housing	Heat dissipation of the built-in condenser via the housing, which is normal. When the housing becomes hot due to high ambient temperature, storage of too much food or shutdown of the compressor, provide good ventilation to facilitate heat dissipation.
	Surface condensation	Condensation on the exterior surface and door seals of the refrigerator is normal when the ambient humidity is too high. Just wipe the condensate with a clean towel.
	Abnormal noise	Buzz: The compressor may produce buzzes during operation, and the buzzes are loud particularly upon start or stop. This is normal. Creak: Refrigerant flowing inside the appliance may produce creak, which is normal.

5. APPENDIX

Installation Instructions

For refrigerating appliances with climate class

Depending on the climate class, this refrigerating appliance is intended to be used at ambient temperature ranges as specified following table. The climate class can be found on the rating plate. The product may not operate properly at temperatures outside of the specified range.

You can find the climate class on the label inside your refrigerator

Effective temperature range

The refrigerator is designed to operate normally in the temperature range specified by its class rating.

Class	Symbol	Ambient temperature range °C	
		IEC 62552 (ISO 15502)	ISO 8561
Extended temperate	SN	+10 to +32	+10 to +32
Temperate	N	+16 to +32	+16 to +32
Subtropical	ST	+16 to +38	+18 to +38
Tropical	T	+16 to +43	+18 to +43

NOTE

The cooling performance and power consumption of the refrigerator may be affected by the ambient temperature, the door-opening frequency, and the location of the refrigerator. We recommend adjusting the temperature settings as appropriate.

Safety Information

Proper Use of Refrigerator

Maintenance of Refrigerator

Trouble Shooting

Appendix



How to store for best preservation (applicable models only)

Cover food to retain moisture and prevent them from picking up odors from other food. A large pot of food like soup or stew should be divided into small portions and put in shallow containers before being refrigerated. A large cut of meat or whole poultry should be divided into smaller pieces or placed in shallow containers before being refrigerated.

Placement of foods

Shelves	Shelves are adjustable to accommodate a variety of packages.
Specialized compartment (applicable models only)	Sealed crisper drawers provide an optimal storage environment for fruit and vegetables. Vegetables require higher humidity while fruit requires lower humidity. Crispers are equipped with control devices to control the humidity level (*depending on model and options). An adjustable temperature meat drawer maximizes the storage time of meat and cheese.
Storage in the door	Do not store perishable food in the door. Eggs should be stored in the carton on a shelf. The temperature of the storage bins in the door fluctuates more than the temperature inside the cabinet. Keep the door closed as much as possible.
Freezer compartment	You can store frozen food, make ice cubes and freeze fresh food in the freezer compartment.

NOTE

Freeze fresh, undamaged food only. Keep food which is to be frozen away from food which is already frozen. To prevent food from losing its flavor or drying out, place in airtight containers.



Safety Information

Proper Use of Refrigerator

Maintenance of Refrigerator

Trouble Shooting

Appendix



