

ELECTRIC FAN

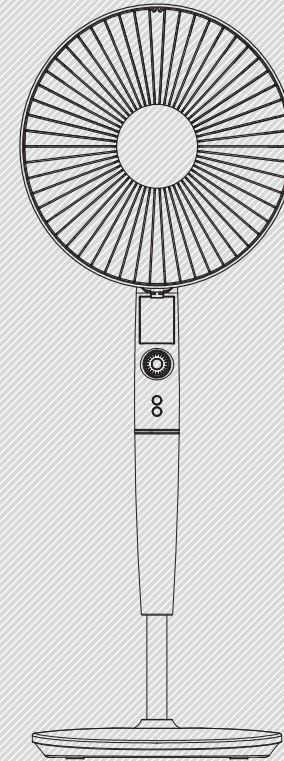

OWNER'S MANUAL

PEDESTAL FAN

MODEL:FS40-15AR

READ AND SAVE THESE INSTRUCTIONS

Attention: Pictures in the IM are for reference only.

Distributed by JH Electrical and Appliance Ltd
570 Mt Wellington Highway, Mt Wellington, Auckland 1062, New Zealand
+64 9 930 0902

CAUTION

Please read the safe operation rules and instructions carefully

WARNING

1. If the power cord is damaged, it must be replaced by manufacturer or its service agent or a similar qualified person in order to avoid any hazard.
2. Indoor use only.
3. To prevent the risk of electrical shock, do not immerse the unit, cord or plug in water or other liquid.
4. This appliance is not intended for use by persons (including children) with reduced physical, sensory or mental capabilities, or lack of experience and knowledge, unless they have been given supervision or instruction concerning use of the appliance by a person responsible for their safety
Young children should be supervised to ensure that they do not play with the appliance.
5. When the appliance is not in use and before cleaning, unplug the appliance from the outlet.
6. When the fan has been assembled, the rotor blade guard shall not be taken off anymore.
7.  Correct Disposal of this product
This marking indicates that this product should not be disposed with other household wastes throughout the EU. To prevent possible harm to the environment or human health from uncontrolled waste disposal, recycle it responsibly to promote the sustainable reuse of material resources.

SAFE OPERATION RULES

1. Never insert fingers, pencils, or any other object through the grille when fan is running.
2. UNPLUG the fan when moving from one location to another.
3. Make sure the fan is on a stable surface when operating to avoid overturning.
4. DO NOT use the fan beside window, rain may create electrical hazard.
5. Household use only.

INSTALLATION INSTRUCTIONS

■ Name of components

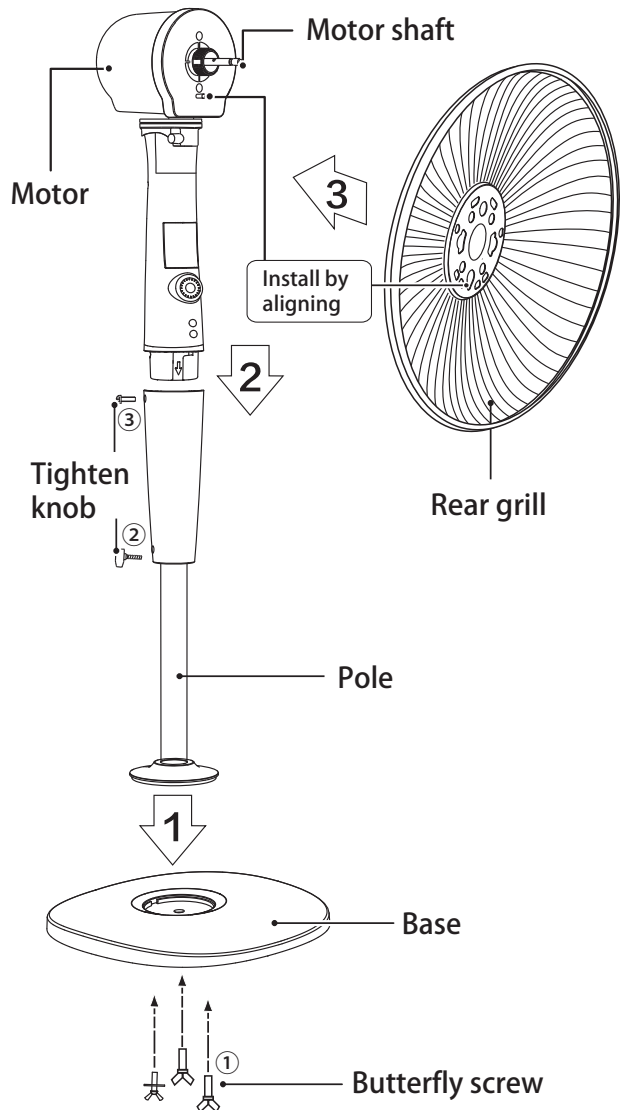

Base Installation

Align the column with the groove on the base and fix them together using butterfly screws.

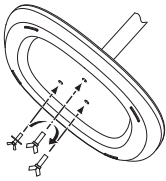

Considerate Hint:
Remove ①②③ parts from the component before performing installation.

Front and Rear Guard Installation

Align Catch of the Front Guard with the illustrated position of the Rear Guard.

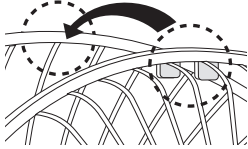

Press guards sequentially with both hands.

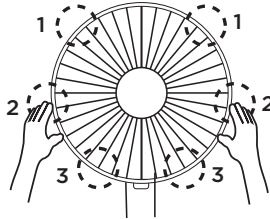

Self-Catch Installation.

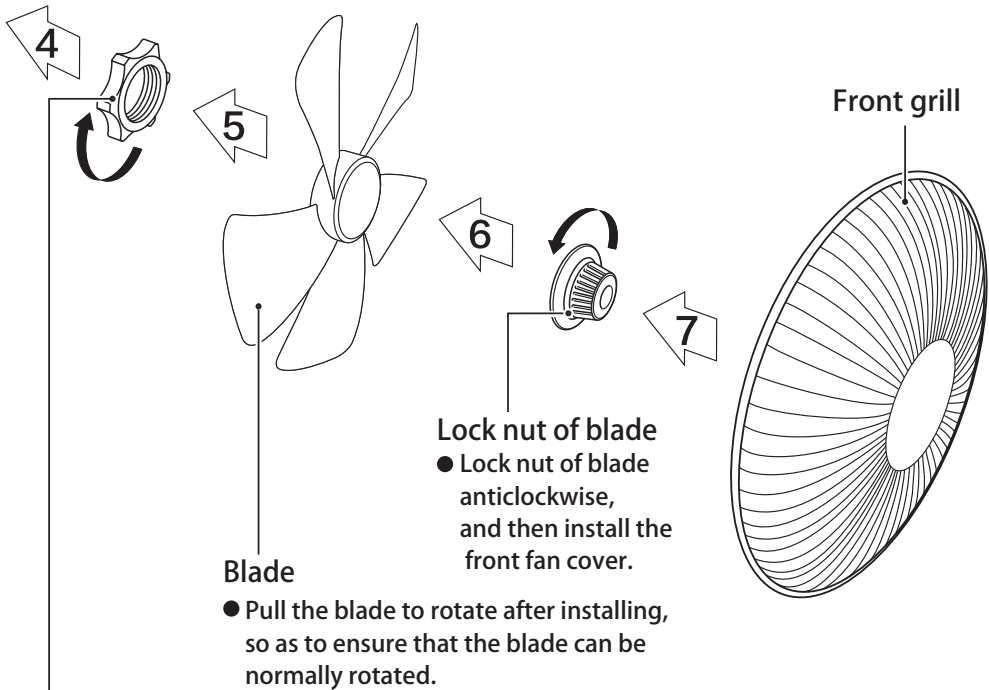
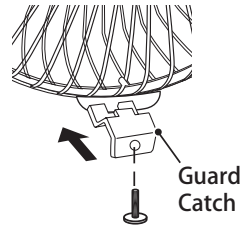

Blade

- Pull the blade to rotate after installing, so as to ensure that the blade can be normally rotated.

Lock nut of blade

- Lock nut of blade anticlockwise, and then install the front fan cover.

Front grill

Lock nut of grill

- Screw the lock nut of grill clockwise, and in the meantime, fix the rear grill.

INSTRUCTIONS FOR USE

■ Instructions for remote controller

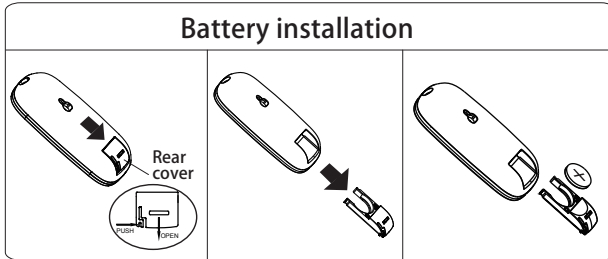
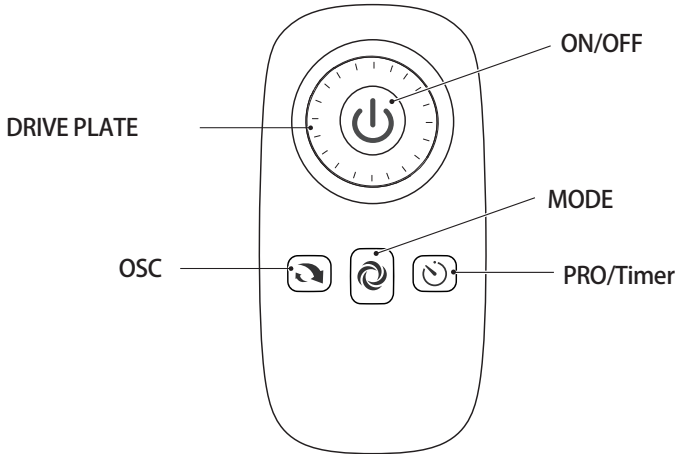

Considerate Hint:

1. Install the battery with positive side facing up.
2. Effective Range of Remote Control: within 5 m distance and 30-degree deflection in front of Product.

■ Instructions for display of body

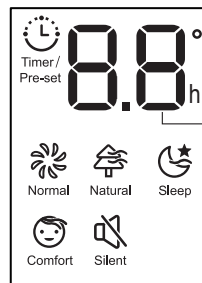

Speed / Timer display

INSTRUCTIONS FOR USE

■ Instructions for operation of body

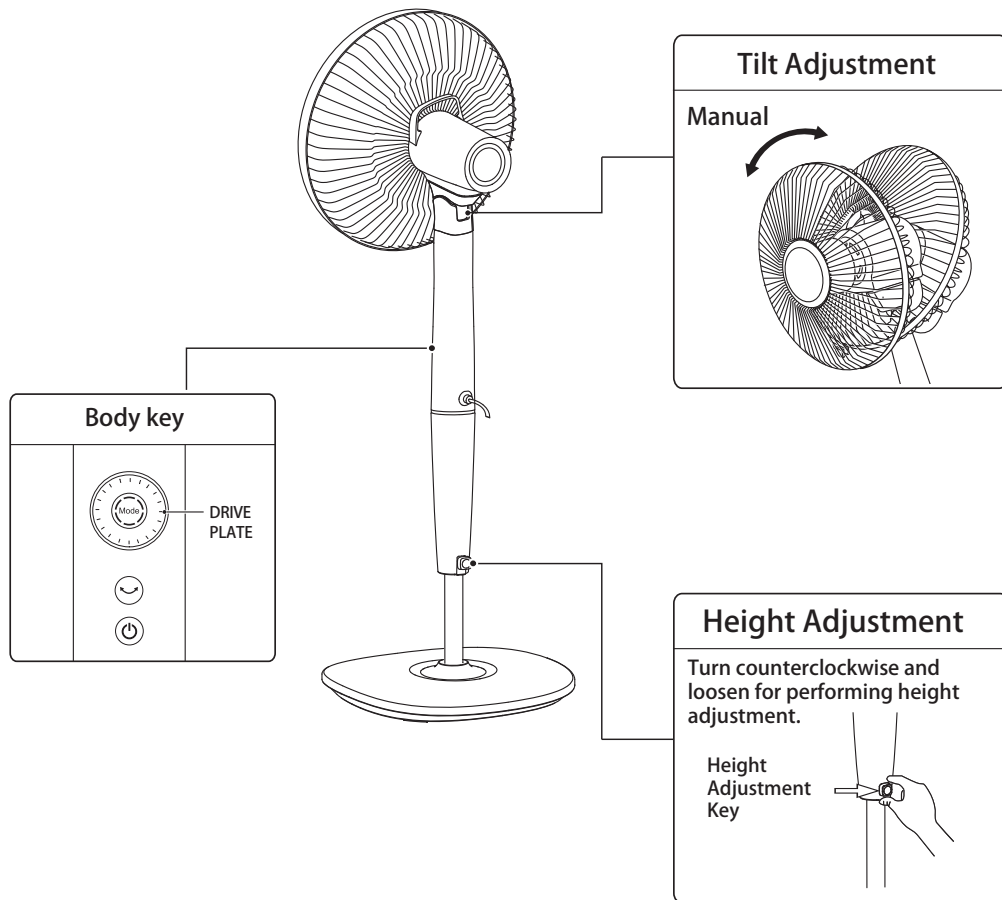

MAINTENANCE INSTRUCTION

The fan requires little maintenance. Do not try to fix it by yourself. Refer it to qualified service personal if service is needed.

1. Before cleaning and assembling, fan must be unplugged.
2. To ensure adequate air circulation to the motor, keep vents at the rear of the motor free of dust. Do not disassemble the fan to remove dust.
3. Please wipe the exterior parts with a soft cloth soaking a mild detergent.
4. Do not use any abrasive detergent or solvents to avoid scratching the surface.
Do not use any of the following as a cleaner: gasoline, thinner.
5. Do not allow water or any other liquid into the motor housing or interior parts.

CLEANING

1. Make sure to unplug from the electrical supply source before cleaning.
2. Plastic parts should be cleaned with a soft cloth moisten with mild soap.
Thoroughly remove soap film with dry cloth.