

# Smart toilet seat Manual

The Product Model:

- ◆ Thanks for choosing our product.
- ◆ And please read the instructions carefully before properly using.

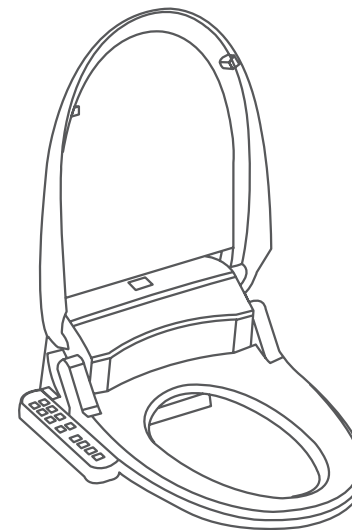

## Contents

Overall sketch .....	1
Safety precautions .....	2
Function introduction .....	4
Installation guide .....	5

## Use

Control panel introduction .....	9
Preparation before use .....	9
Product use .....	10
Cleaning and maintenance .....	15

## Appendix

Product specification .....	18
Packing list .....	19

## Overall sketch

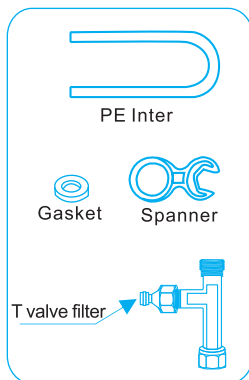
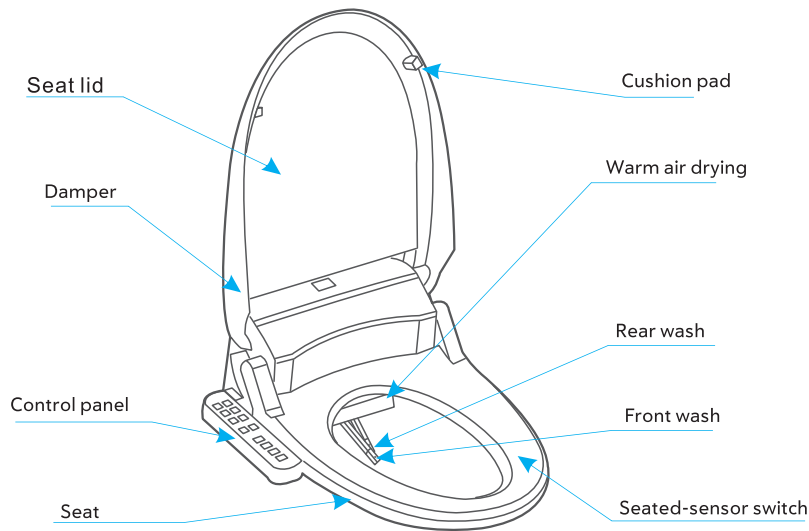

Water pipeline connecting accessories

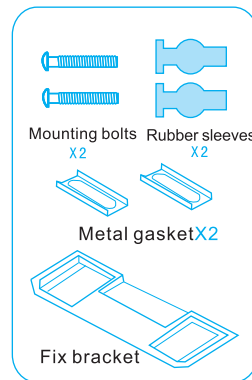

Fix machine parts

**Attention:**  
The specification, design and color of the instruction may differ from the end-product you bought. In the case, you'd better refer to the end-product about the assemblies.

## Safety Precautions

All the safety precautions listed can prevent the users from the physical hurts or property losses. Please read all the safety items and warnings, using the product in the right way.

**WARNING** Ignoring the sign may lead to serious injury or death.

**Don't disassemble, repair, alter the product.**

- ◆ All the behaviors above may lead to fire or electric shock.
- ◆ The product needs to be repaired professionals.

**Don't immerse the product into the water. If the operating Environment has a quite high humidity, please install scavenging port and seal the attaching plug with rubber.**

**Don't touch the plug with the wet hand.**

- ◆ It may lead to electric shock.

**Connect the grounding wire with the product to prevent electric leakage or electric shock.**

- ◆ If the grounding wire is not connected with the product, it may lead to electric leakage or shock.
- ◆ The grounding wire needs to be connected with the product by a professional.

**Don't power on before pouring water. The power supply should not be higher than 220-240V**

- ◆ It may cause fire.

**Don't use the loosening plug. The electric wire should not be scratched, damaged, processing, bending, stretching bundling, hang heavy things or clamp.**

- ◆ It may cause electric shock or fire.

**⚠ WARNING**

Ignoring the sign may lead to serious injury or death.



Don't stand on the toilet seat cover, seat circle or any other accessories.

- ◆ It may cause break down the product.



Don't open up and close down the toilet seat or toilet cover roughly.

- ◆ It may crack the toilet seat circle or toilet cover and lead to electric leakage.



Don't drag or bend the water pipe.

- ◆ It may make water leakage or no water supply.

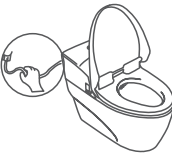

Don't install or leave the remote control near the water.

- ◆ It may break down the remote control.



Preventing damage from freeze.

- ◆ The inlet tube and the inner of the product may be damaged for freezing, and then lead to water leakage.



Attention to the low temperature scalding.

- ◆ After using a long period, please turn off the heat preservation button near the seat circle.
- ◆ Please turn off the button for these groups: children, elders, patients, people unable to adjust the temperature, people with weak skin, people taking sleeping pills, alcoholics, the tired.



Don't put heat instruments beside the substance.

- ◆ It may change the color of the substance or even break down the substance. Please avoid the direct sunshine.
- ◆ Sometimes it may change the color of the plastics. Don't cover the warm air outlet.
- ◆ It may cause fire injury.



The substance cover, seat circle and seat cover are all plastics products. Don't bring fire source like cigarette butt, ashtray near these assemblies.

- ◆ It may lead to fire.

Declaration: In the event that accident occurs as a result of improper usage, company will assume no responsibility.

**Function introduction:**

	Introduction
Rear wash	Wash posterior
Rear oscillating wash	Rear wash with nozzle swinging
Front wash	Gentle wash for women only
Front oscillating wash	Gentle front wash with nozzle swinging
Temperature control	Adjust seat and water temperature
Water pressure adjustable	Adjust water pressure for washing
Seat sensor	Functions activated by sitting on the seat
Heated seat	Make you feel comfortable and warm at cold winter
Warm air dryer	Dry wash position
Drying intensify control	Adjust drying temperature
Power on/off	Control power
Energy saving	Electricity saving system
Nozzle self-cleaning	Nozzle spray out water for cleaning
Mute anti-collision	Built in damper, close seat slowly

## Installation Guide

### ❖ Installation environment

1. Before installation, toilet wall, floor tile, ceramic toilet has been completed, bathroom should advance water and 220-240V power socket near by toilet.
2. Water pressure should be between 0.06Mpa(flow)-0.75MPa (Static),water temperature 4°C-35°C.
3. Fozen case, please put the product in a warm place wait to melt then install it.
4. Connect daily-use water pipe only. Connect with recycled water, industrial water conduct, will possibly initiate the infection, and will cause internals jamming or breakdown
5. Please be sure to use incidental T valve and filter.
6. Don' t put the power plug into the socket before finished install.

### ❖ Install T valve

1. Lock inlet valve to remove water pipe. See Picture 1.
2. Connect Tvalve, filter and inlet valve. See picture 2.
3. Install flush tank and inlet pipe. See picture 3.

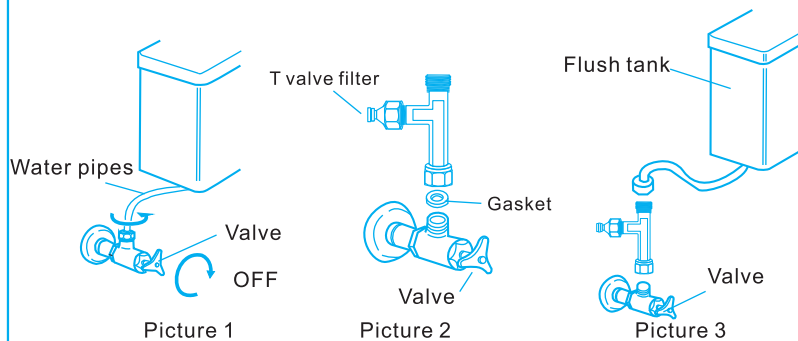

### ❖ Install bidet

#### ① Remove original toilet seat

1. Loss nut.
2. Take out toilet seat.

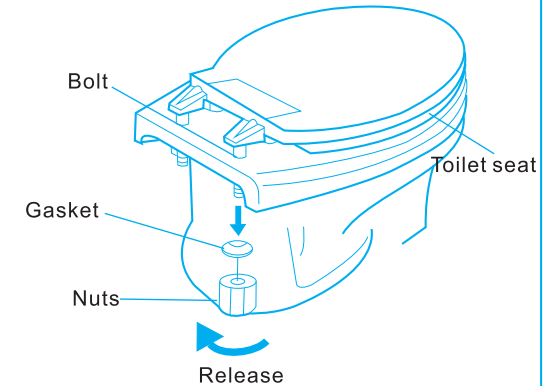

#### ② Install fix bracket

1. put the rubber sleeves into toilet installation hole.
2. put the fix bracket on toilet then start to install it.
3. with the mounting bolts on the bcket fixed the toilet .

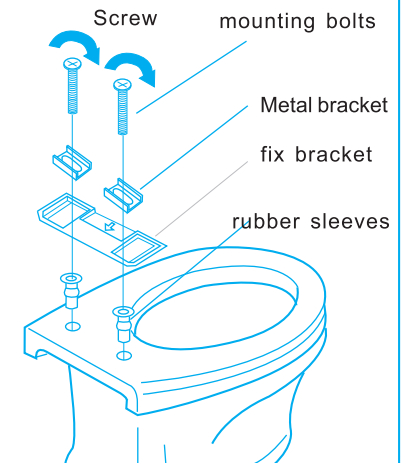

- ❖ The fix bracket can adjust the rang within 130-170mm

## ※ Install bidet

### ③ Install bidet

Push the product slip into fix bracket and left bidet to send it into fitter place

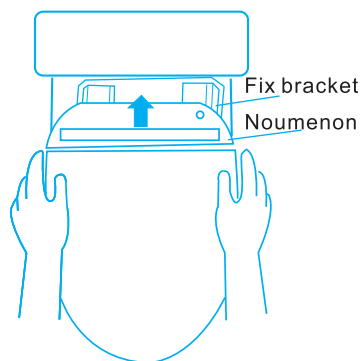

※ Notice: please don't forget the power cable between the toilet and bidet.

Be sure the bidet fixed as complete then left bidet to fit it on correct position.

## ※ connect inlet pipe

### ① Connect T valve

- 1、 Take out clip from connector of T valve.
- 2、 Hold on PE Inter to push it towards connector of T valve.
- 3、 Reinstall clip to original position.

### ② Connect bidet

- 1、 Take out clip from connector at the side of bidet.
- 2、 Hold on PE inter to push it towards connector of bidet.
- 3、 Install the clip to connector of T valve
- 4、 Reinstall clip to original position.

※ Turn on inlet valve after connected, please check the connector part leakage or not.

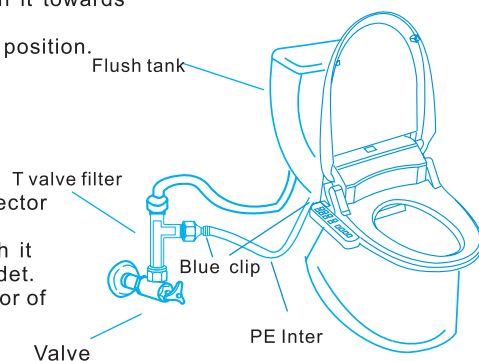

## ※ Preparation for water supply and Test for operation

- 1、 Insert electric plug into the socket.
- 2、 When the indicator light is on, all indicator lights are shining, at the same time, water flows into the inner water tank, the process will cost about 11s. Then water sprays out from the nozzle. All indicator lights are off with a sound “Di” for once.
- 3、 Press the power button on toilet or on remote controller, then the power indicator light is on, and the toilet is in the condition of work.
- 4、 Adjust temperature of water and toilet seat to appropriate condition
- 5、 Follow the instructions to operate, press buttons as told, and test every action.

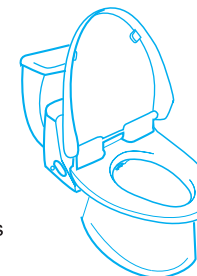

# Use

## ◆ Control panel introduction

※ In order to instruct well, this picture shows all conditions on control panel.

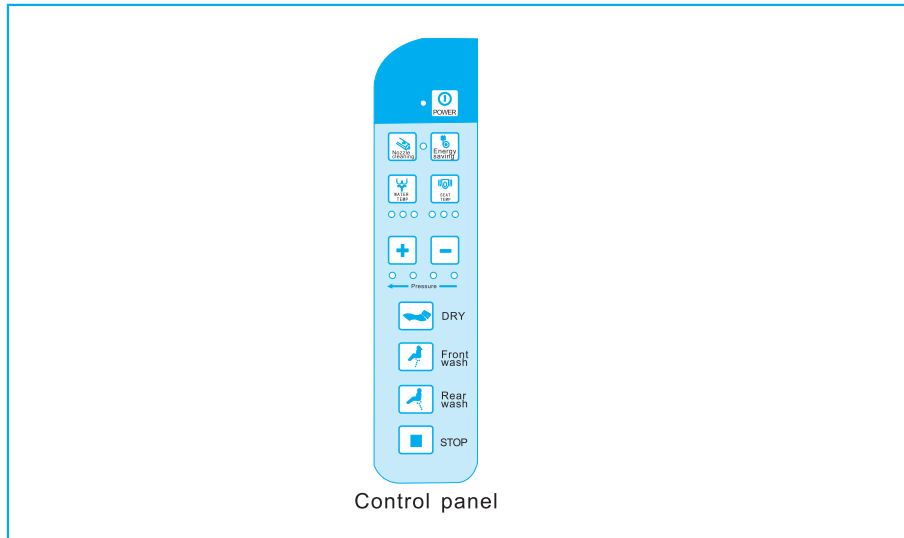

## ◆ Preparations before Use

1. Ensure the plug is inserted into socket and the indicator light is on.

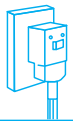

2. Open the water-inlet valve

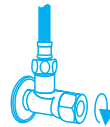

3. Confirm the control panel power indicator is on



4. Press the power button on the panel confirm power indicator is on otherwise it can not be operated.



## ◆ Product use

### sit on the toilet seat

Seated-sensor activated "sitting" Lights nozzle cleans itself for once If air purification is activated, deodorizing function operates automatically.



### Rear wash (commonly used)

Wash rear

### Stop button

Turn off rear wash or Front wash 2mins after pressing the button, wash stops automatically

### Massage wash

Press  or  button to start wash press again to start massage wash, repress it to stop

### Water pressure adjustable button

Four-pressure setting for choose adjust comfortable water pressure by pressing

### Front wash for women only

Wash rear with women only nozzle

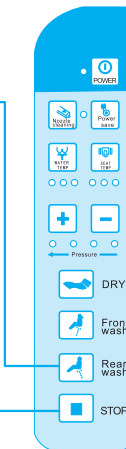

### Nozzles cleanse

Press the  on control panel then clean water flows out to clean nozzles

- ※ Nozzles cleanse is available while people are unseated.
- ※ Before rear wash and Front wash nozzle will clean peripheral part automatically, so nozzles are not easily dirtied.
- ※ Or you can pull out nozzles and clean them manually.

### Warm air dryer adjustable button

Four-dryer setting for choose, adjust comfortable air drying by pressing.

### Drying

blow out warm air to dry wash position

### Stop button

Turn off drying, or it will automatically stop after 4 mins.

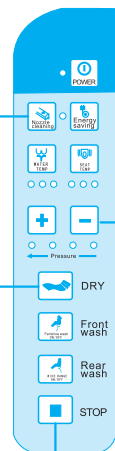

### Water temperature control

Press  to start water temperature setting.

Four temperature setting for choose. When at 1,2,3 grade, water will be heated According to setting.

When at room temperature grade, water Will not be heated. Water-Temperature Grade will change with one button press, and the grade will show on the control panel.

Note:  
if the sign is not showed on the panel, this function is unavailable.

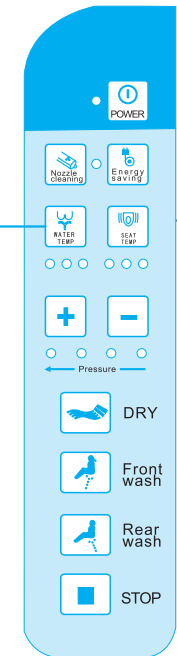

### Seat temperature control

Press  to start seat temperature setting. There are four-temperature setting for choose, when at 1,2,3 grade, seat will be heated according to setting. seat will not be heated. when at common-temperature Grade, seat-temperature grade will change with one button press

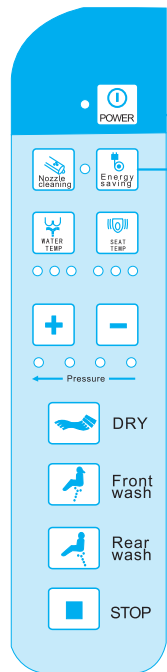





### Power

Press the  on control panel the toilet will be powered off.  
To power on the toilet, press  again, then  lights.

### Energy saving

Press  to enter the energy saving mode.  
The  will be on 1.5mins after the system stop working. And then the whole system goes into an energy saving mode. Water and seat temperature remain in 25°C. If there are any operations during this time, the system will go back in to the mode before energy saving mode.

### Buzzer

#### Buzzer

Buzz once: Normal operation-receives instructions from the buttons or the remote control  
Buzz twice: Auto operates when users stand up  
Buzz three times or above: Indicates malfunction or disorders. Buzzing intervals depends.

### Indicator light

#### Indicator light

power indicator	When the power is on, the indicator light is on. If there is something wrong with flushing components, the indicator light will shine.
seat temperature indicator	When the toilet seat is heating, the indicator light is on. If it is over heated, the indicator light will shine.
water temperature Indicator	When the water is heating, the indicator light is on. If it is over heated, the indicator light will shine.
seat indicator	When seated, the indicator light is on. If water level is low, the indicator light will shine.
energy saving indicator	When it goes into energy saving mode, the indicator light is on.



## Cleaning and Maintenance

### ● Cleaning the Toilet Seat

- ◆ Do not use corrosive solvents to clean the toilet seat, such as banana oil, benzene, decolorizer, cleaner, and diluter. Also do not use water to rinse the equipment as this may cause short circuits, resulting in a fire.
- ◆ Pull out the plug before cleaning in case that plug or the outlet gets wet by water.
- ◆ Scrub the toilet seat gently by soft cloth. If it is very dirty, get the cloth wet and clean the unit by neutral agents.

### ● Cleaning and Maintenance the Nozzle

- ◆ Press Nozzle Cleaning Button and water sprays out. Press the button a second time then the rear nozzle extends and press again, feminine nozzle extends too. Clean the nozzles with brush.

#### ◆ Replacing the Nozzle

Hold the front end of the nozzle tip and turn it counterclockwise when nozzle extends. Then pull out of it. Replace the tip, insert it into the nozzle and turn it clockwise.

\*\*Do not force the nozzle tip out or bend it.

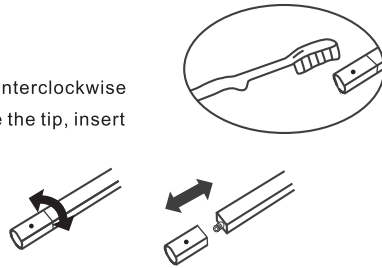

### ● Cleaning the filter

When the water pressure is too low or insufficient, please clean the filter.

- 1 Close the shutoff valve and stop water supply.  
Notice: Do not remove the filter without closing the shutoff valve, otherwise water will spray out.

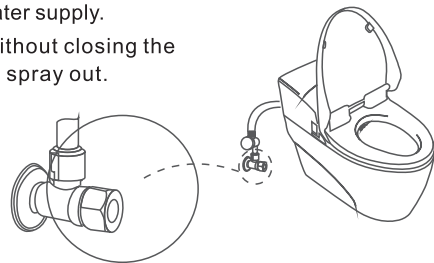

- 2 **Disassemble filter**  
please use spanner to back-out one touch fitter, take out filter in T valve; turn on the cover of filter to take out filter, please see picture.

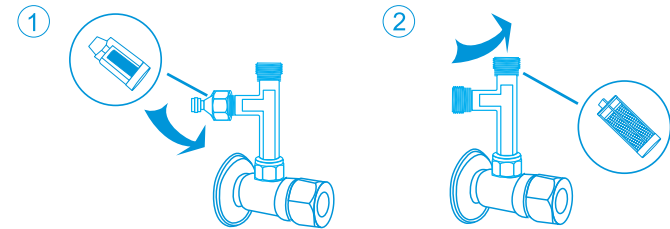

- 3 **Clean**  
Take out filter to clean the scale via brush. Please wash it in clear water or brush. Notice: please don't use detergent to clean it. Please softly wash the filter net to avoid net deformation

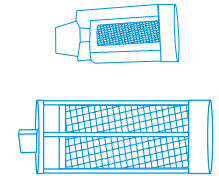

- 4 **Reinstall**  
Reinstall the net and others in turn. Notice: tighten up the filter in special spanner, turn on the inlet valve to check it leakage or not.

### ● Long time no use

- ◆ please turn off inlet valve and power supplier when out of house as long time or don't use it. Please don't turn off inlet valve and power when room temperature lower than 0°C, your bidet will enter anti-freeze program automatically.

## Daily wash

### ◇ Daily wash

Disassemble and install

- 1、 Take out plug from socket.
- 2、 Turn off inlet valve.
- 3、 Grip the bidet to pull out, separate it with ceramic toilet.
- 4、 Clean surface of bidet and toilet.
- 5、 Reinstall it after clean bidet and toilet. Grip the bidet to slid it into bracket to hear a sound 'ka' mean in correct position.
- 6、 Make sure the bidet tight fit with the toilet.
- 7、 Turn off inlet valve and put plug into socket.



## Warning

1. This appliance is not intended for use by persons (including children) with reduced physical, sensory or mental capabilities, or lack of experience and knowledge, unless they have been given supervision or instruction concerning use of the appliance by a person responsible for their safety.
2. Children should be supervised to ensure that they do not play with the appliance.
3. If the supply cord is damaged, it must be replaced by the manufacturer, its service agent or similarly qualified persons in order to avoid a hazard.

## Appendix

### Product specification

Rated voltage	AC220-240V 50Hz
Rated power consumption	1520w (When the inflow water is 15 degrees, set the outflow temperature and strength to the maximum.)
Power cord length	1.5m
Cleansing and Flushing	
Water pressure range	0.06Mpa(dynamic)-0.75Mpa(Static)
Water pressure adjustment	Adjustable in 4 levels
Water Temp. Adjustment	Adjustable in 4 levels: 33℃, 36℃, 39℃, (Room Temperature)
Rated power	1600W
Safety Device	Temperature control system; Over-heated protection mechanism; Over-dried protection mechanism; water and electricity isolation system.
General cleansing flow rates	0.5-0.9L/min(Minimum required water pressure:0.15Mpa)
Feminine cleansing flow rates	0.5-0.9L/min(Minimum required water pressure:0.15Mpa)
Seat Heating	
Surface temperature	Adjustable in 4 levels: 33℃, 36℃, 39℃ (Room Temperature)
Safety device	Temperature control system; Over-heated protection mechanism
Warm Air Dryer	
Warm air temperature	Adjustable in 4 levels from 32℃ to 62℃
Safety Service	Temperature Reset Switch/Temperature fuse

## ◆ Packing List ◆

Dear my user

Please check whether the products are complete after you open the box of toilet.

Product packaging box containing the items are:

- 1 toilet seat
- 1 manual
- 1 spanner
- 1 filter
- 1 rubber gasket
- 1 front wash nozzle(backup)
- 1 rear wash nozzle(backup)
- 1 PE inlet tube
- 1 fix bracket
- 2 metal gasket
- 2 mounting bolts
- 2 rubber sleeves

