

CHILDREN'S ELECTRONIC TOY MOTORCYCLE

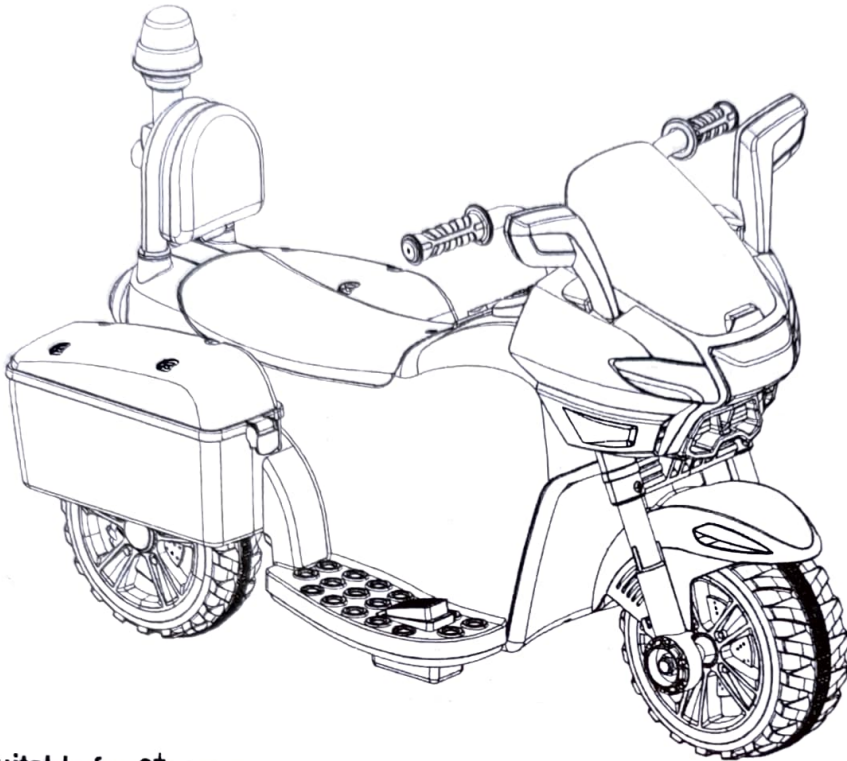

- Suitable for 2+ years
- Maximum user weight: 25kg
- Adult assembly required

OWNER'S MANUAL

Read and understand this entire manual before using!

Please keep this manual for future reference as it contains important information.

Before first time use, charge the battery for at least 8-12 hours, no more than 20 hours.

Table of Contents

1. About Your New Motorcycle
2. Parts List
3. Parts Diagram
4. Assembly Steps
5. How To Operation Your Motorcycle
6. Charging The Motorcycle
7. Troubleshooting Guide
8. Maintaining Your Motorcycle
9. Disposal Of Battery

About Your New Motorcycle

Thank you for your purchasing our products, we wants your child to enjoy this product for years to come. Keep these points in mind as you read this guide:











Suitable age:	2+ years	Battery:	DC 6V 4.0AH *1
Load Capacity:	Under 25Kg	Size of car:	770*425*500mm
Speed:	2.5-3Km/h	Carton size:	645*355*330mm
Material:	PP	Optimum Temperature:	Below 40°C Avoid to use under burning sun
Charger:	Input: Shown on the charger	Charging time:	8-12 hours, at most 20 hours
	Output: DC 6V	Fuse:	F 5A, Self-resetting
	Current: DC 0.5A	Operating life:	12 months to 18 months

WARNING!

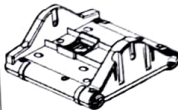
FOR THE SAFETY OF YOUR CHILD, PLEASE READ ALL WARNINGS AND ASSEMBLY/USE INSTRUCTIONS. KEEP THIS GUIDE FOR FUTURE REFERENCE.

- **ADULT ASSEMBLY REQUIRED.** The product contains small parts, which are for adult assembly only. Keep small children away when assembling.
- Always remove protective material and poly bags and dispose before assembly.

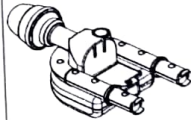
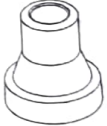
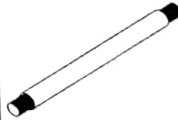
Parts List

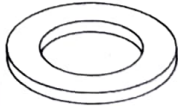
PART No	PART NAME	PICTURE	Qty (pcs)	REMARKS	PART NO	PART NAME	PICTURE	Qty (pcs)	REMARKS
1	Vehicle body		1		2	Left handlebar		1	
3	Right handlebar		1		4	Mudguard		1	
5	Fork brace		1		6	Head cover		1	
7	Windshield		1		8	Front wheel		1	
9	Backrest		1		10	Shaft sleeve		2	Placed in the front axle
11	Front axle		1		12	M8 Nut		2	Placed in the front axle
13	M10 Washer		4	Placed in the front axle					

Parts List

Assembly package				
PART NO	PART NAME	PICTURE	QTY (pcs)	REMARKS
14	Rear view mirror		1 pair	Left & right
16	Protective sleeve		2	
18	M5 Nut		6	
20	M8X170 Bolt		1	
22	Instruction manual		1	
24	Spanner		2	
15	Decorative cover		1 pair	Left & right
17	M5X28 Bolt		6	
19	M4X10 screw		6	
21	M8 Nut		1	
23	Charger		1	

Parts Diagram

1	Vehicle body *1	2	Left handlebar*1	3	Right handlebar*1
4	Mudguard *1	5	Fork brace*1	6	Head cover *1
7	Windshield*1	8	Front wheel*1	9	Backrest*1
10	Shaft sleeve *2	11	Front axle*1	12	M8 Nut*2
13	M10 Washer*4	14	Rear view mirror*2	15	Decorative cover*2
16	Protective sleeve*2	17	M5X28 Bolt*6	18	M5 Nut *6
19	M 4X10Screw*6	20	M8X170 Bolt*1	21	M8 Nut*1

NOTE: Some Parts Shown are assembled on both sides of vehicle

Tools Required



Screwdriver(not included)



Pliers(not included)



Hammer(not included)

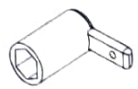

Spanner

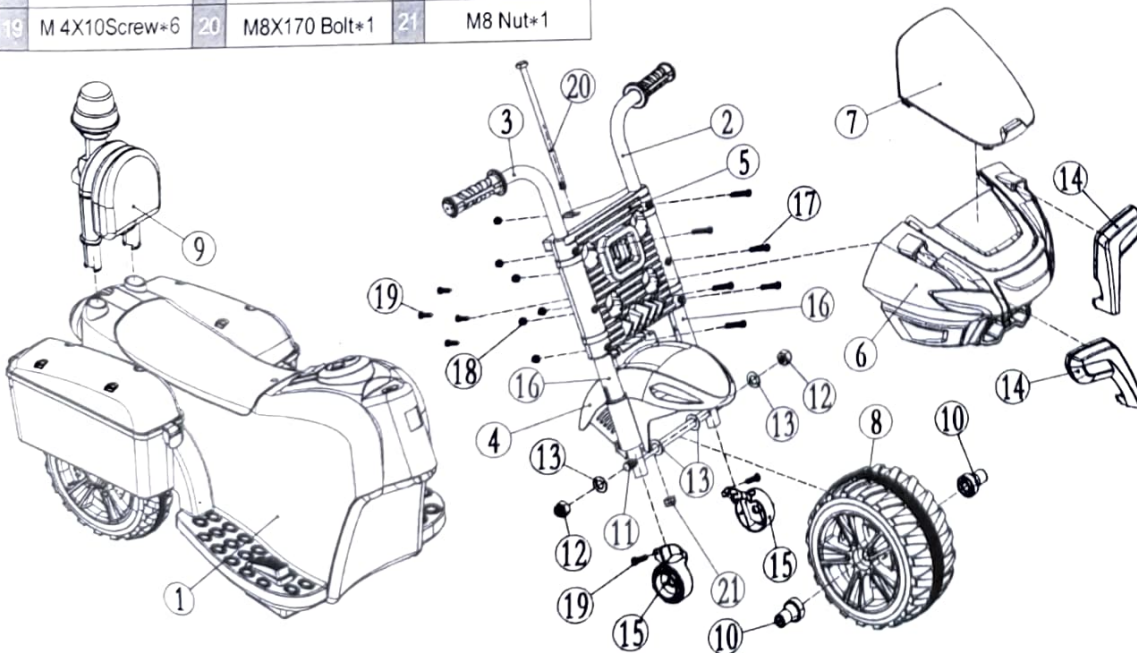

Assembly Steps

- Your new motorcycle requires adult assembly. Please set aside at least 40 minutes for assembly. Children can be harmed by small parts, sharp edges and sharp points in the vehicle's unassembled state. Care should be taken in unpacking and assembly of the vehicle. Children should not handle parts, or help in assembly of the vehicle.
- Please identify all parts before assembly and save all packaging material until assembly is complete to ensure that no parts are discarded.
- Assembly tool for need: screwdriver(not included), pliers(not included), hammer(not included), spanner.

1. Install the left handlebar .

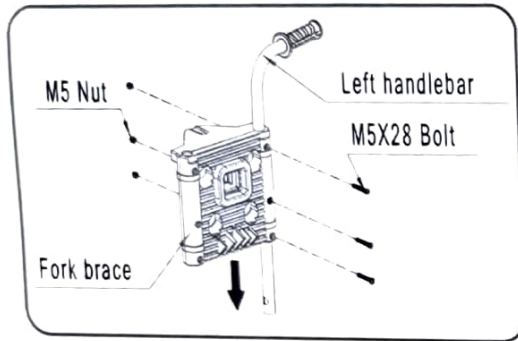

- As shown in the picture, Install the left handlebar to the fork brace and then fasten with the bolt and nut.

NOTE: don't turn upside down when installing the fork brace.

2. Install the right handlebar .

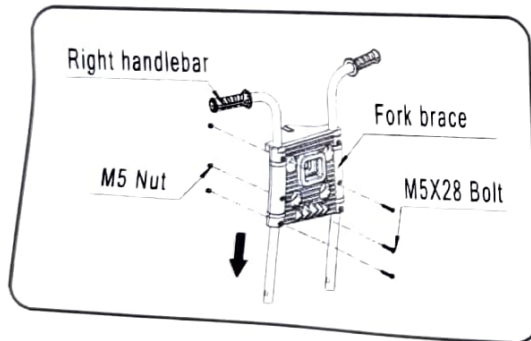

- As shown in the picture, Install the right handlebar to the fork brace and then fasten with the bolt and nut.

Assembly Steps

3. Install the head cover.

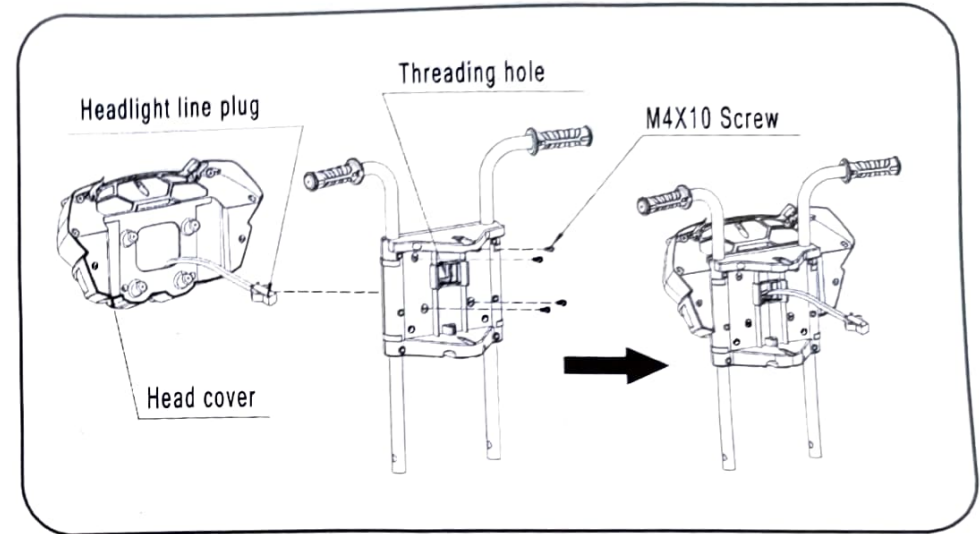

- As shown in the picture, put the headlight line plug through the threading hole.
- As shown in the picture, Install the head cover to the fork brace and then fasten with the screws.

4. Install the windshield.

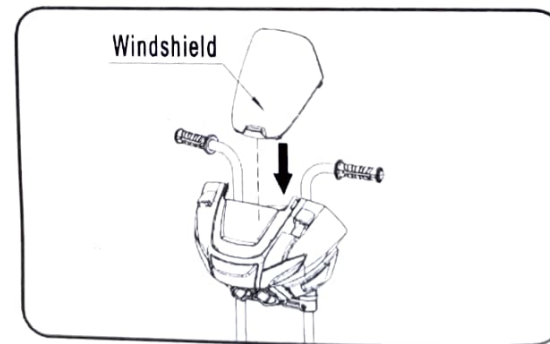

- As shown in the picture, press the windshield downward to fix it.

Assembly Steps

5. Connect the headlight line plug.

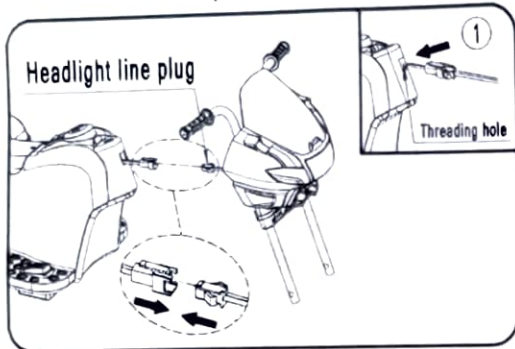

- The headlight line plug butt.
- As shown in Figure 1, put the headlight line plug into threading hole, don't have a wire exposed.

6. Install the headstock.

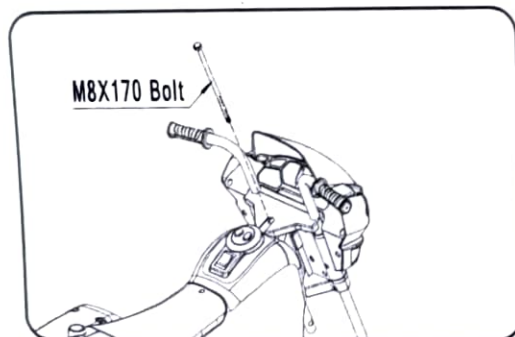

- As shown in the picture, put the bolt through the headstock.

7. Install the protective sleeve.

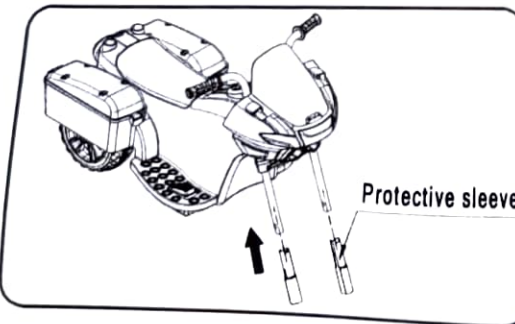

- As shown in the picture, put the protective sleeve through the handlebar.

NOTE: don't turn upside down when installing the protective sleeve.

Assembly Steps

8. Install the decorative cover.

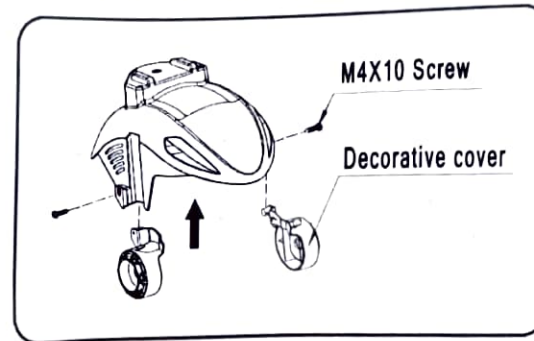

- As shown in the picture, install the decorative cover to the corresponding place, and fasten with the screws.

9. Install the mudguard.

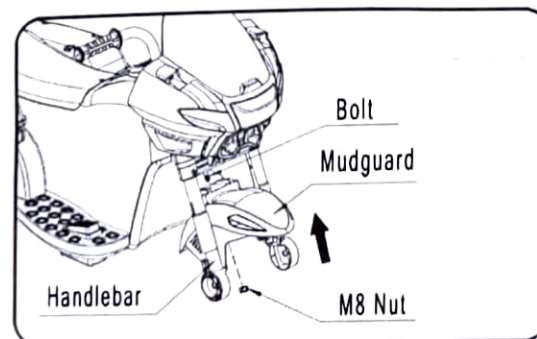

- As shown in the picture, put the mudguard through the handlebar and bolt, and fasten with the nut.

Assembly Steps

10. Install the front wheel.

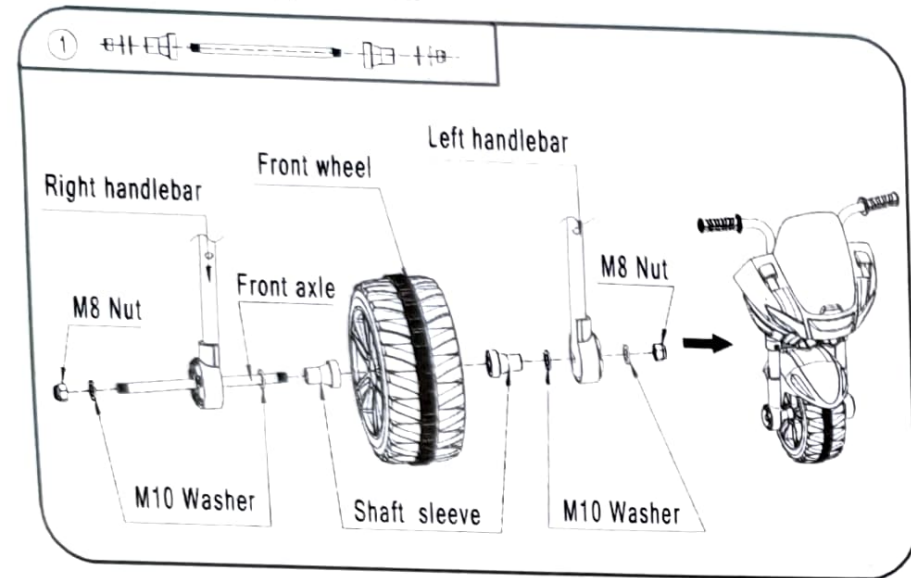

- As shown in Figure 1, disconnect the front axle parts.
- As shown in the picture, put the front axle through the right handle, sequentially installed washer, shaft sleeve, front wheel, shaft sleeve, washer.
- Then through the left handle, and install washers to both sides and fasten with nuts.

11. Connect the power supply.

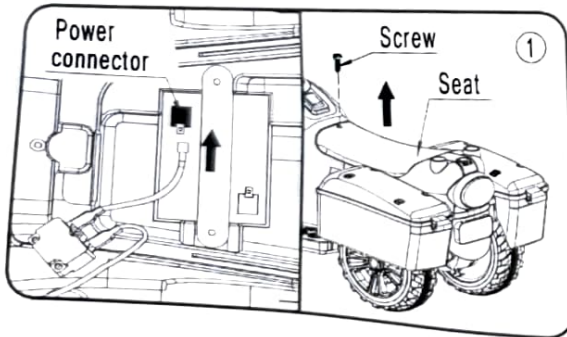

- As shown in Figure 1, unscrew the screw, and open the seat.
- Plug the power connector into the terminal on battery as shown.
- Then install the seat to the corresponding place, and fasten with the screw.

Assembly Steps

12. Install the Battery.

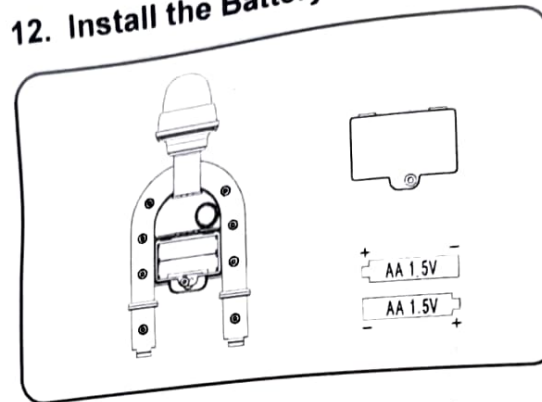

Loosen battery cover of backrest and remove the cover. Insert two AA1.5V batteries (See above photo). Replace battery cover.

- non-rechargeable batteries are not to be recharged;
- different type of batteries or new and used batteries are not to be mixed;
- batteries are to be inserted with the correct polarity;
- exhausted batteries are to be removed from the toy;
- the supply terminals are not to be short-circuited.
- rechargeable batteries are only to be charged under adult supervision;
- rechargeable batteries are to be removed from the toy before being charged;
- The transformers or battery charger used with the toy are to be regularly examined for damage to the cord, plug, enclosure and other parts, and in the event of such damage, they must not be used until that damage had been repaired.

Assembly Steps

13. Install the backrest .

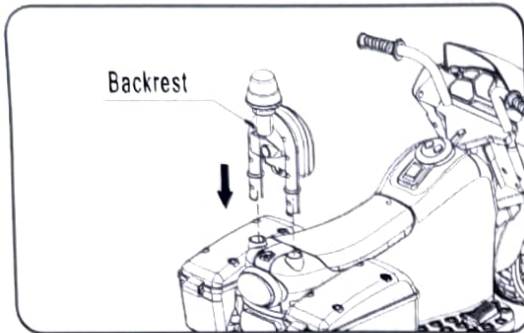

- As shown in the picture, press the backrest downward to fix it .

14. Install the rear view mirror .

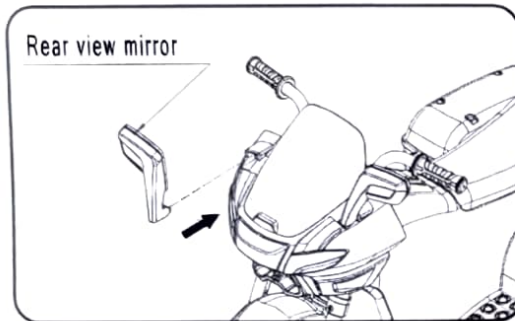

- As shown in the picture, press the rear view mirror downward to fix it.

IMPORTANT SUPPLEMENT TO INSTRUCTION MANUAL



GAP

After assembling any wheel to the axles, please check the gap between the screw thread and the collapsible (refer to below picture), if the gap is too big, please add two or three washers inside the wheel, But after tightening the nut outside the wheel, please turn the wheel by your finger to check if the wheel can run smoothly, this is very important, because if the wheel can run smoothly, it is ok, but if the nut press the wheel and the wheel can't run smoothly, the motor will be broken easily! Then you need to decrease one or two washers to make sure the wheel can run smoothly!

How To Operate Your Motorcycle

! WARNING!

PREVENT INJURIES AND DEATHS:

• **NEVER LEAVE CHILD UNATTENDED. DIRECT ADULT SUPERVISION IS REQUIRED.** Always keep child in view when child is in vehicle.

- Never use in roadways, near cars, on or near steep inclines or steps, swimming pools or other bodies of water.
- Always wear shoes.
- Always sit on the seat.
- Suitable for age 2+ years; Maximum user weight is 25kgs.
- Not to be used in traffic .

Must confirm before using that following work which is already finished:

- **Important!** Before using the vehicle for the first time, the battery needs to be charged for 8 to 12 hours, no more than 20 hours. Only an adult can charge or recharge the battery.
- Finishing the complete motorcycle to assemble according to the steps that the manual described. The plug-in package of storage battery has already been inserted well, the power has already been put through.
- All places to need the screw guarantee the screw has already been locked.

Rules for Safe Riding

READ THESE RULES ALOUD TO YOUR CHILD AND THEIR PLAYMATES AND MAKE SURE THEY UNDERSTAND THEM!

- This toy is no break. Always wear a helmet and protective clothing when riding.
- Direct Adult Supervision Required.
- Keep Children within Safe Riding Areas:
- Never use in roadway, near motor vehicles, on lawn space, on or near steep inclines or steps, swimming pools or other bodies of water.
- Use the toy only on flat surfaces. such as inside your house, garden or playground.
- Never use in the dark. A child could encounter unexpected obstacles and have an accident. Operate the vehicle only in the daytime or a well-lit area.
- It is not recommended to drive the vehicle on wet surfaces or on lopes of greater than 15 degrees.
- Do not use this vehicle outdoors when it is raining or snowing.
- Make sure you come to a complete stop before changing directions *from forward to back*.
- Please follow the correct weight and age limits allowed to drive this vehicle.
- It is prohibited to change the circuit or add other electric parts
- Inspect wires and connections of the vehicle periodically.
- In order to avoid accidents, please ensure the vehicle is safe *before riding*.
- Do not let any child touch the wheels or be near them *when the car is moving*.

How To Operate Your Motorcycle

Use Operation

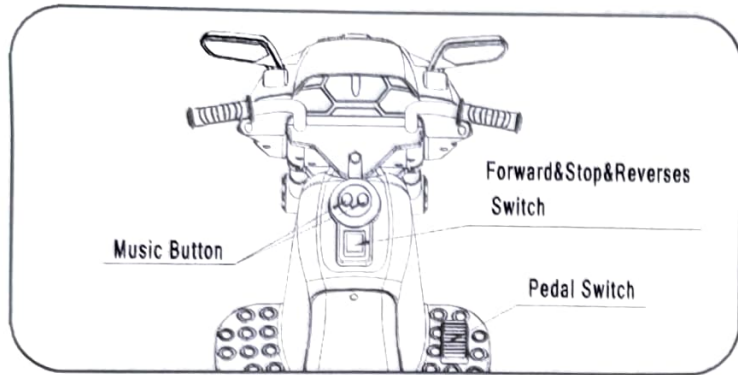

IMPORTANT!

Always stop vehicle when changing the speed or direction to avoid damage the gear box and motor.

- (1) Forward
Press the "Forward and Stop and Reverse switch" to the "Forward" position.
Press the pedal.
The vehicle drives forward.
- (2) Stop
Press the "Forward and Stop and Reverse switch" to the "Stop" position.
Remove foot from the accelerator pedal to stop the car.
- (3) Reverse
Press the "Forward and Stop and Reverse switch" to the "Reverse" position.
Press the pedal.
The vehicle drives backward.
- (4) You can enjoy music by push any music button,

(5) How to Alarm lamp :

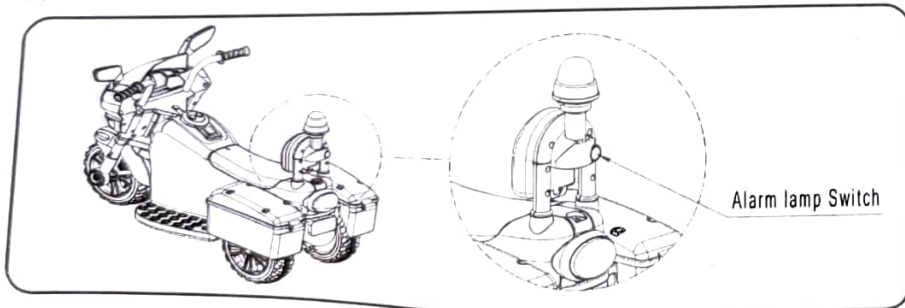

- As shown in the picture, turn off the " Alarm lamp switch", the light is not bright.

How To Operate Your Motorcycle

Circuit diagram

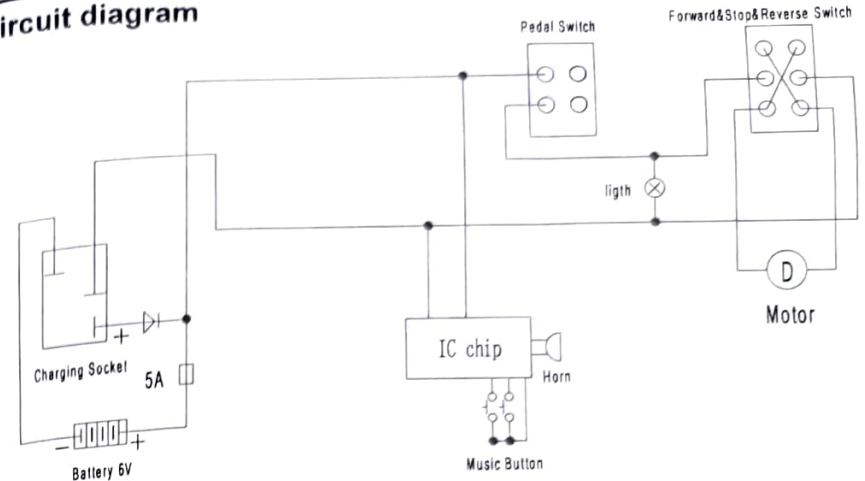

Charging Your Motorcycle

ONLY AN ADULT CAN CHARGE AND RECHARGE THE BATTERY!

⚠ WARNING!

• PREVENT FIRE AND ELECTRIC SHOCK:

- Use the only rechargeable battery and charger supplied with your vehicle. NEVER substitute the battery or the charger with another brand. Using another battery or charger may cause a fire or explosion.
- Do not use the battery or charger for any other product. Overheating, fire or explosion could occur.
- NEVER modify the electric circuit system. Tampering with the electric system may cause a shock, fire or explosion or may permanently damage the system.
- Do not allow direct contact between battery terminals. Fire or explosion can occur.
- Do not allow any type of liquid on the battery or its components.
- Explosive gasses are created during charging. Do not charge near heat or flammable materials. Charge the battery in a well-ventilated area ONLY.
- NEVER pick up the battery by the wires or charger. Damage can occur to the battery and may cause a fire. Pick up the battery by the case ONLY.
- Charge the battery in a dry area ONLY.
- Battery posts, terminals and related accessories contain lead and lead compounds, chemicals known to the State of California to cause cancer and reproductive harm. **Wash hands after handling.**
- Do not open the battery. Battery contains lead acid and other materials that are toxic and corrosive.

Charging Your Motorcycle

! WARNING!

• PREVENT FIRE AND ELECTRIC SHOCK:

- Do not open the charger. Exposed wiring and circuitry inside case may cause electric shock. Only adults may handle or charge the battery. NEVER allow child to handle or charge the battery. Battery is heavy and contains lead acid (electrolyte).
 - Do not drop the battery. Permanent damage to the battery could occur or cause serious injury.
 - Before charging the battery, check for wear or damage to the battery, charger, its supply cord and the connectors. DO NOT charge the battery if any damage to parts has occurred.
 - Do not allow the battery to drain completely. Recharge the battery after each use or once a month if not used regularly.
 - Do not charge battery upside down.
 - Always secure the battery with the bracket. Battery can fall out and injure a child if vehicle tips over.
 - A recommendation for adult supervision of young children.
 - The toy should be used with caution since skill is required to avoid falls or collisions causing injury to the user or third parties.
- The charging input socket is **LOCATED IN THE REAR OF VEHICLE BODY** .
- The **POWER SWITCH** must be turned in **OFF** position when charging.
- Before the first use, you should charge the battery for 8-12 hours. Do not recharge the battery for more than 20 hours to avoid overheating the charger.
- When the vehicle begins to run slowly, recharge the battery.
- After each use or once a month minimum recharge time as 8 to 12 hours, no more than 20 hours.

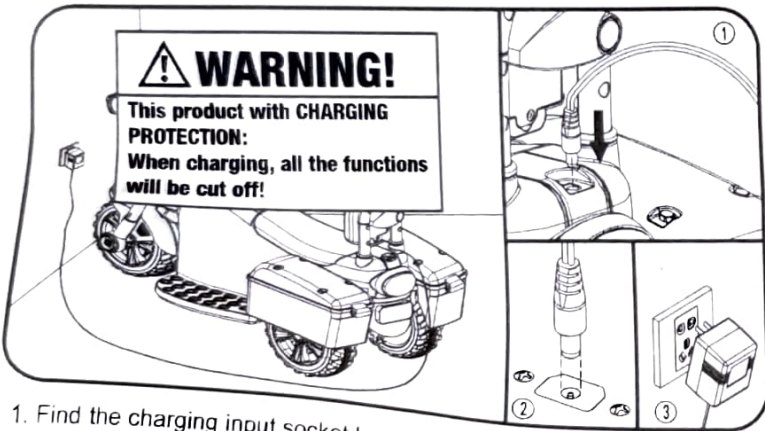

1. Find the charging input socket located in the rear of vehicle body;
2. Plug the charger port into the input socket;
3. Plug the charger plug into a wall outlet. The battery will begin charging.

Troubleshooting Guide

■ PROBLEM: The vehicle does not run

PROBLEM CAUSE: The battery may low on power.

After each use, or once a month minimum, charge the battery for 8-12 hours. Do not leave the battery on the charger for more than 20 hours.

POSSIBLE CAUSE: Thermal fuse has tripped.

The vehicle is equipped with a self-resetting fuse. When the vehicle is overloaded or operated incorrectly; the self-resetting fuse will be cut off for 5-20seconds before becoming operational again. The self-resetting fuse is under the seat (Refer to the picture.)

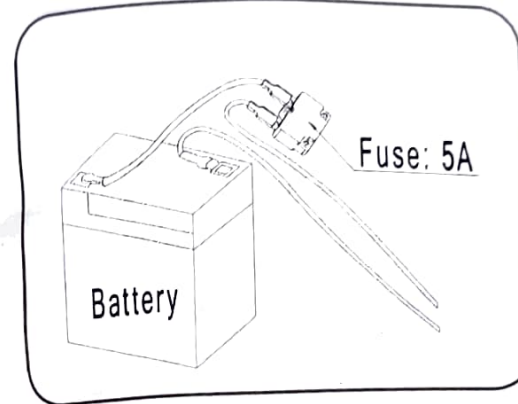

To avoid the fuse cut off the power, follow these guidelines:

- DO NOT overload the vehicle. Maximum weight allowed :25kg
- DO NOT tow anything behind the vehicle.
- DO NOT drive up steep slopes.
- DO NOT drive into fixed objects, which may cause the wheels to spin, causing the motor to overheat.
- DO NOT drive in very hot weather, components may overheat.
- DO NOT tamper with the electric system, Doing so may create a short circuit, causing the fuse to trip.

POSSIBLE CAUSE: Wheel nuts are loose.

If the nuts are not tight, the wheels will not engage the forward gears. Tighten the nut with the nut wrench.

POSSIBLE CAUSE: Battery connector or wires are loose.

Make Sure the battery connectors are firmly plugged in to each other.

POSSIBLE CAUSE: Battery is dead.

Have you properly maintained the battery according to the directions? Is the battery old? Your battery may need to be replaced.

POSSIBLE CAUSE: Electric system is damaged.

Water may have corroded the system, or loose dirt, gravel or sand might have jammed the switch.

POSSIBLE CAUSE: Motor is damaged.

The motor needs professional repair.

■ PROBLEM: The battery will not recharge.

POSSIBLE CAUSE: Battery connector or adapter connector is loose.

Make sure the battery connector and adapter connector are firmly plugged together.

POSSIBLE CAUSE: Charger is not plugged in.

Make sure the charger is plugged into the wall outlet and the power flow to the outlet is on.

POSSIBLE CAUSE: Charger is not working.

Is the charger warm while charging? If not, the charger may be broken and may need to be replaced.